

16509-09 1/2-11-11 1/2 Prairie Ave.

APPLICATION FOR BUILDING PERMIT

1

DIVISION OF BUILDING AND SAFETY

Department of County Engineer
County of Los Angeles
WM. J. FOX, COUNTY ENGINEER
CASSATT D. GRIFFIN, SUPERVISOR OF BUILDING

BUILDING ADDRESS *16509-16509 1/2 - 11-11 1/2 La Prairie*
LOCALITY *Lawndale*
NEAREST CROSS ST. *165th*

FOR APPLICANT TO FILL IN

BUILDING ADDRESS *16509-16509 1/2 - 16511-11 1/2*

LOT NO. *395* BLOCK

TRACT *6286*

SIZE OF LOT *38x116.85* NO. OF BLDGS. NOW ON LOT

USE OF EXISTING BLDG.

OWNER *FLOYD OLSON*

MAIL ADDRESS *1158 TREMINE AVE*

CITY *Los Angeles* TEL. NO.

ARCHITECT OR ENGINEER *F. CAMANITI* TEL. NO.

ADDRESS *15502 CRENSHAW BLVD*

CONTRACTOR *E.E. ORR* TEL. NO. *TE 47307*

ADDRESS *23714 GULF BLVD WILM.*

DESCRIPTION OF WORK

NEW ADD ALTER REPAIR DEMOLISH

SQ. FT. SIZE *1331* NO. OF STORIES *1* NO. OF FAMILIES *4*

USE OF STRUCTURE *APARTMENTS*

SIGNATURE OF APPLICANT *Earl E. Orr*

ADDRESS *23714 GULF BLVD WILMINGTON*

\$ VALUATION *9900*

P. C. \$ FEE *12.00*
\$ FEE *24.00*

I HEREBY ACKNOWLEDGE THAT I HAVE READ THIS APPLICATION AND STATE THAT THE ABOVE IS CORRECT AND AGREE TO COMPLY WITH ALL COUNTY ORDINANCES AND STATE LAWS REGULATING BUILDING CONSTRUCTION.

SIGNATURE OF PERMITTEE *Earl E. Orr*

ADDRESS *23714 GULF BLVD WILM.*

DISTRICT NO. *7* GROUP *A* TYPE *I* SEWER MAP BK *B146* PG

MAP NUMBER *4157* STATE HWY YES NO

USE ZONE *R-4* SPECIAL CONDITIONS *no piping*

BUILDING SETBACK YARD HWY STREET NAME EXIST. WIDTH

FRONT P. L. *30'* *Prairie* *80'*

SIDE P. L.

0 TRACT DWELL. 1 UNIT 5 INDUSTRIAL

1 DWELL. 1 UNIT 6 PUBLIC BLDG.

2 DUPLEX 4 UNIT 7 ADDN., ALT., ETC.

3 APT. 4 UNITS 8 MISCEL.

4 COMMERCIAL

INSPECTION RECORD

23714 Gulf Blvd. WILM. 9/20/56
foundations walls & partitions only. 929 Bosnak

APPROVALS

| | DATE | INSPECTOR'S SIGNATURE |
|---------------------------------------|----------------|-----------------------|
| FOUNDATION: LOCATION FORMS, MATERIALS | <i>9-20</i> | <i>BOSNAK</i> |
| FRAME: FIRE STOPS, BRACING, BOLTS | <i>12-20</i> | <i>BOSNAK</i> |
| FURNACE: LOCATION, GAS VENT, DUCTS | <i>12-20</i> | <i>BOSNAK</i> |
| LATH, INT. | <i>12-20</i> | <i>BOSNAK</i> |
| LATH, EXT. | <i>12-20</i> | <i>BOSNAK</i> |
| HOUSE NUMBER CORRECT AND POSTED | <i>3-9-56</i> | <i>BOSNAK</i> |
| FINAL | <i>3-12-56</i> | <i>BOSNAK</i> |

WM. J. FOX, COUNTY ENGINEER

VALIDATION

C. N. DIRLAM, CHIEF BLDG. INSPECTOR

ACo 2958 SEP 12 1956

12 ACo 3907 SEP 23 1956

24.00

W. Hunter

W. Hunter

APPLICATION FOR PERMIT SEWER-SEWAGE DISPOSAL 1

DIVISION OF BUILDING AND SAFETY
Department of County Engineer
County of Los Angeles
JOHN A. LAMBIE, COUNTY ENGINEER.
CASSATT D. GRIFFIN, SUFF. OF BUILDING

FOR APPLICANT TO FILL IN

| LEGAL DESCRIPTION | LOT NO. 395 | |
|-------------------|--|---------------------|
| BLOCK | TRACT 6286 | |
| SIZE OF LOT | NO. OF BLDGS. NOW ON LOT 1 | |
| USE OF BUILDINGS | Residential | |
| CONTRACTOR | C. D. Williams | |
| ADDRESS | 3738 Hale Ave - | |
| CITY | Long Beach TEL. NO. LA. 77208 | |
| REGISTRATION NO. | 148030 <input type="checkbox"/> STATE <input type="checkbox"/> COUNTY | |
| NO. | DESCRIPTION OF WORK | FEE |
| 1 | HOUSE SEWER CONNECTING TO PUBLIC SEWER | \$ 3.50 3 50 |
| | SEPTIC TANK, SEEPAGE PIT OR PITS AND/OR DRAINFIELD | \$ 3.00 |
| | OVERFLOW SEEPAGE PIT, DRAINFIELD EXTN., CESSPOOL, DRYWELL, MANHOLE | \$ 2.00 |
| | HOUSE SEWER CONNECTING TO PRIVATE DISPOSAL SYSTEM | \$ 1.00 |
| | CONNECT ADDITIONAL BLDG. OR WORK TO HOUSE SEWER | \$ 3.00 |
| | ALTER, REPAIR OR ABANDON HOUSE SEWER OR DISPOSAL SYSTEM | \$ 1.00 |

| | | | | |
|------------------------------|-----------|----|---|----|
| OWNER'S AUTHORIZATION | PERMIT | \$ | 1 | 00 |
| | TOTAL FEE | | 4 | 50 |

I HAVE AT THIS DATE A CONTRACT WITH THE HEREIN NAMED CONTRACTOR TO CONNECT THE ABOVE DESCRIBED EXISTING DWELLING TO THE PUBLIC SEWER.

SIGNED THIS _____ DAY OF _____ 19____

OWNER OR OWNERS AGENT **new**

ADDRESS _____

I HEREBY ACKNOWLEDGE THAT I HAVE READ THIS APPLICATION AND STATE THAT THE ABOVE IS CORRECT AND AGREE TO COMPLY WITH ALL COUNTY ORDINANCES AND STATE LAWS REGULATING PLUMBING AND SEWERS.

I HEREBY CERTIFY THAT I AM PROPERLY REGISTERED AND/OR LICENSED AS REQUIRED BY LOS ANGELES COUNTY AND STATE OF CALIFORNIA OR THAT I AM THE LEGAL OWNER OF THE ABOVE DESCRIBED RESIDENTIAL PROPERTY.

SIGNATURE OF PERMITTEE **W. Williams**

| | |
|--|----------|
| BUILDING ADDRESS 16509. Yacivil ave | |
| LOCALITY Long Beach | |
| NEAREST CROSS ST. 165th | |
| OWNER Floyd Olson | |
| MAIL ADDRESS 1126 Therman ave | |
| CITY L.A. | TEL. NO. |

| DISTRICT NO. 7 | GROUP H | MAP BK PG B 146 |
|--|-------------------------------|---|
| CONNECTION DATA | | |
| STATION 20+89.8 | DEPTH 7 | |
| MANHOLE REFERENCE 109.5 5 | | <input type="checkbox"/> UPPER <input checked="" type="checkbox"/> LOWER |
| TYPE OF CONNECTION (Y) CURB | P.L. | LENGTH FROM M.L. TO P.L. 5 |
| CO. IMP. NO. 1050 | P. C. NO. - | JOB NO. |
| TRUNK PERMIT NO. - | ROAD PERMIT NO. 325287 | |
| STATE ENCROACHMENT PERMIT NO. - | | |
| INDUSTRIAL WASTE APPROVAL - | | |
| CHARGES | | |
| CONNECTION CHARGE FEE | | |
| REIMBURSEMENT FEE | | |
| APPROVALS | | |
| NEW HOUSE SEWER | DATE 1-16-36 | INSPECTOR'S SIGNATURE W. Wood |
| CONNECT ADDITIONAL BUILDING OR WORK | | |
| SEPTIC TANK, SEEP. PIT(S) AND/OR DRAINFIELD | | |
| CCESSPOOL <input type="checkbox"/> DRYWELL <input type="checkbox"/> | | |
| ALTER, REPAIR, SEWER OR SEWAGE DISPOSAL SYSTEM | | |
| DISCONNECT PLUG AND ABANDON HOUSE SEWER | | |
| BACKFILL SEPTIC TANKS <input type="checkbox"/> | | |
| SEEP. PIT(S) <input type="checkbox"/> CESSPOOLS <input type="checkbox"/> | | |

JOHN A. LAMBIE, COUNTY ENGINEER **VALIDATION** ROBERT A. WOOD, CHIEF PLBG. INSPECTOR

CR. M. O. CASH

NO. 89533 JAN 9 4 450

Epacorn

REQUIRED INFORMATION

1. INDICATE ALL BUILDINGS ON PROPERTY.
2. INDICATE AND DIMENSION SEWAGE DISPOSAL SYSTEM WITH THE DISTANCES TO BUILDINGS AND PROPERTY LINES.
3. INDICATE SIZE OF SEPTIC TANK—DEPTH OF SEEPAGE PITS—SIZE OF CESSPOOLS.
4. INDICATE NORTH DIRECTION ON PLOT.
5. INDICATE BOTH STREETS IF CORNER.

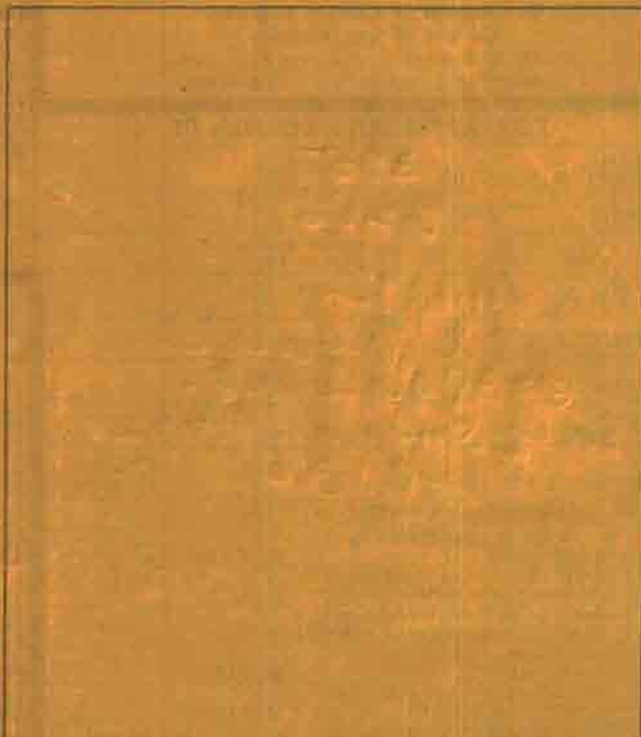

ST. ALLEY R/W

FIELD NOTES



CITY OF LAWDALE
COUNTY OF LOS ANGELES
DEPARTMENT OF PUBLIC WORKS
BUILDING AND SAFETY DIVISION



14717 BURIN AVENUE
 LAWDALE, CA 90260
 PH: (310) 973-3237

Building (Basic) Permit
PERMIT NUMBER:
PR20150000830

| | | | | | | |
|--|---|---|---------------|---------------------|--------------|-------------------|
| LEGAL ID: | DESCRIPTION | BUILDING ADDRESS: | | | | |
| ASSESSOR INFORMATION NUMBER: 4074019016 | WORK ITEMS: Basic Building (fee based on cost valuation) Qty: UoM: Amt. Tot. 1.00 Val 3,985.00 3,985.00 | 16509 PRAIRIE AVE, LAWDALE, CA 90260 | | | | |
| OWNER: HOEINGHAUS, JOHN D 944 JOANN ST COSTA MESA, CA 92627 | FEES: | PROCESSED BY: SBurnam | | | | |
| TEL. NO: | Issuance Fee 33.60 | PC.SUBMITAL ISSUED ON: 28 Sep 2015 | | | | |
| APPLICANT: | Basic Building (fee based on cost valuation) 160.50 | EXPIRES ON: 26 Mar 2016 | | | | |
| TEL. NO: | Building Group R/Other Fee 0.50 | FINAL DATE: 10/14/15 | | | | |
| CONTRACTOR: J TAYLOR ROOFING INC 1860 W. 169TH STREET, CN, 3103787733 | Green Building Standards Fee (GBSF) 1.00 | USE ZONE: | GROUP: | CONST. TYPE: | DIST: | FIRE ZONE: |
| TEL. NO: | Processing Fee 99.15 | R-2 | R-3 | V-B | 7.01 | 3 |
| LICENCE NO: | TOTAL FEES PAID: 294.75 | STATISTICAL CLASSIFICATION: 85 | | | | |
| ARCHITECT OR ENGINEER: | | DESCRIPTION OF WORK: SCRAPE RACK OFF ROOF AND INSTALL NEW MODIFIED BITUMEN TORCH APPLIED ROOF OVER EXISTING 1 LAYER OF ROOFING AT PROPERTY ADDRESS 16509 S. PRAIRIE AVENUE | | | | |
| LICENCE NO: | | SPECIAL CONDITIONS: | | | | |
| LEAD HAZARD WARNING: Due to the possible presence of lead-based paint, lead-safe work practices are required for all repairs that disturb paint in pre-1979 buildings. Failure to do so could create lead hazards that violate California Health and Safety Code, Sections 17920.10 and 105256 with potential fines for violations up to \$5,000 (Section [d] amended) or imprisonment for not more than 6 months in the county jail or both. For more information call 1-800-LA-4-LEAD. | | APPROVAL | DATE | INSPECTOR | | |
| | | Location (Setback & Yards) | | | | |
| | | Foundations | | | | |
| | | Slab | | | | |
| | | Frame/Sheeting | 9/29/15 | | | |
| | | Energy Insulation | | | | |
| | | Lath/Drywall-Interior | | | | |
| | | Lath-Exterior | | | | |
| | | House Number - Correct & Posted | | | | |
| | | Final | | | | |
| | | Certificate of Occupancy Issued | | | | |
| | | Planning | | | | |

INSPECTOR COPY

THIS PERMIT WILL EXPIRE IF CONSTRUCTION IS NOT STARTED WITHIN SIX (6) MONTHS OF THE DATE APPROVED BY THE BUILDING OFFICIAL. CONSTRUCTION ACTIVITY MAY BE CONDUCTED BETWEEN THE HOURS OF 7 A.M. AND 7 P.M., MONDAY THROUGH FRIDAY (EXCEPT NATIONAL HOLIDAYS), AND 8 A.M. AND 5 P.M. SATURDAYS. CONSTRUCTION ACTIVITY IS PROHIBITED AT ALL OTHER HOURS AND ON SUNDAYS AND NATIONAL HOLIDAYS. Printed on: 28 Sep 2015

APPLICATION FOR PLUMBING PERMIT

1

DIVISION OF BUILDING AND SAFETY

Department of County Engineer
County of Los Angeles
WM. J. FOX, COUNTY ENGINEER
CASSATT D. GRIFFIN, SUP'T OF BUILDING

FOR APPLICANT TO FILL IN

OWNER Eul Orr
 MAIL ADDRESS _____
 CITY _____ TEL. NO. _____
 PLUMBER Henry C Larson
 ADDRESS 4635 Manhattan Beach Blvd
 CITY Lomdale TEL. NO. Q5 5760
 LICENSE NO. 1492

| NUMBER | TYPE OF FIXTURE OR ITEM | FEE |
|--------|-------------------------|------|
| 2 | WATER CLOSET (TOILET) | 5320 |
| | BATH TUB | |
| 2 | SHOWER | 320 |
| 2 | LAVATORY (WASH BASIN) | 320 |
| 2 | KITCHEN SINK | 320 |
| | DISHWASHER | |
| | LAUNDRY TUB OR TRAY | |
| | CLOTHES WASHER | |

TOTAL NO. 16 @ 0.80 = 1280

4 GAS SYSTEM 12 OUTLETS @ 1.00 = 400
4 WATER HEATER @ 1.00 = 400

PERMIT \$ 1.00
 TOTAL FEE 2080

I HEREBY ACKNOWLEDGE THAT I HAVE READ THIS APPLICATION AND STATE THAT THE ABOVE IS CORRECT AND AGREE TO COMPLY WITH ALL COUNTY ORDINANCES AND STATE LAWS REGULATING PLUMBING.

I HEREBY CERTIFY THAT I AM PROPERLY REGISTERED AND/OR LICENSED AS REQUIRED BY LOS ANGELES COUNTY AND STATE OF CALIFORNIA OR THAT I AM THE LEGAL OWNER OF THE ABOVE DESCRIBED RESIDENTIAL PROPERTY.

SIGNATURE OF PERMITTEE Henry C Larson

BUILDING ADDRESS 16509 Prairie Ave
 LOCALITY LA County
 NEAREST CROSS ST. _____

| DISTRICT NO. | GROUP | ZONE | READY FOR INSPECTION |
|--------------|-------|------|----------------------|
| 7 | H | R-4 | |

INDUSTRIAL WASTE APPROVAL _____

INSPECTION RECORD

1) GENERAL LEAKS IN WATER & VENTS (16-17) 12-7-58 Basnak
MAIN C.O. TO BE ACCESSIBLE 12-14 Basnak
PAINT TEST ON 165090916
NG. REPT DR 2-27-58 Basnak

APPROVALS

| | DATE | INSPECTOR'S SIGNATURE |
|----------------------|----------|-----------------------|
| UNDER SLAB WORK | 10-13-58 | Basnak |
| ROUGH PLUMBING | 12-14 | Basnak |
| GAS PIPING | 12-14 | Basnak |
| GAS VENT | | |
| HOT WATER HEATER | 2-27 | Basnak |
| PLUMBING FIXTURES | 2-27 | Basnak |
| GAS TEST | 3-9-58 | Basnak |
| UTILITY CO. NOTIFIED | 3-12-58 | Basnak |
| FINAL | 3-12-58 | Basnak |

WILLIAM J. FOX, COUNTY ENGINEER

VALIDATION

R. A. WOOD, CHIEF PLBG. INSPECTOR

16460219 OCT 6 3 21.80

M. H. Hall

APPLICATION FOR ELECTRIC PERMIT

DIVISION OF BUILDING AND SAFETY

Department of County Engineer
County of Los Angeles
WM. J. FOX, COUNTY ENGINEER
CASSATT D. GRIFFIN, SUP'T OF BUILDING

| | |
|-------------------|----------------------|
| BUILDING ADDRESS | 16511 1/2 S. Prairie |
| LOCALITY | Lawndale |
| NEAREST CROSS ST. | |
| OWNER | Earl E. Orr |
| MAIL ADDRESS | 23714 Gulf Ave. |
| CITY | |
| TEL. NO. | |
| ELECTRICIAN | Blevins Electric |
| ADDRESS | 12204 Burl Ave. |
| CITY | Hawthorne |
| TEL. NO. | OS 6-8195 |
| LICENSE NO. | 149883 (C10) |

FOR APPLICANT TO FILL IN PERMIT FEES

| | NUMBER | EACH | FEE | |
|-------------------------------|------------|------------|------------|--------|
| LIGHT OUTLETS | 13 | | | |
| RECEPTACLES | 29 | | | |
| WALL SWITCHES | 20 | | | |
| TOTAL OUTLETS | 62 | 5¢ | \$ 3 | 10 |
| ELEC. RANGES | | 25 | | |
| ELEC. HEATERS | | 25 | | |
| KW EA | | | | |
| FIXTURES | 13 | 5 | | 65 |
| NUMBER OF LIGHT CIRCUITS | | | | |
| NUMBER OF RECEPTACLE CIRCUITS | | | | |
| MOTORS | | | | |
| NUMBER | HORSEPOWER | | FEE | |
| NEW | MVD. | HP | OVER | INC. |
| 4 | | 1 | 1/2 & LESS | \$.25 |
| | | | 1/2 | 2 |
| | | | 2 | 5 |
| | | | 5 | 15 |
| | | | 15 | 50 |
| | | | 50 | 200 |
| | | | | 5.00 |
| MISC. | | | | |
| NO. SIGNS | | NO. TRANS. | | |
| NO. SIGNS | | NO. LAMPS | | |
| FOR EACH PERMIT: | | | | |
| WIRING | | | \$ 1.00 | 1 00 |
| FIXTURES | | | \$ 1.00 | 1 00 |
| SUPPLEMENTARY | | | .50 | |
| TOTAL FEE | | | \$ 6 | 75 |

| | | | |
|--------------------------------|-------|------|----------------------|
| DISTRICT NO. | GROUP | ZONE | READY FOR INSPECTION |
| 7 | H | RY | |
| INSPECTION RECORD | | | |
| ① 1/2" VCC TUB - (Cable + ...) | | | |
| OL 12-7 BOSNAK | | | |

APPROVALS

| | DATE | INSPECTOR'S SIGNATURE |
|----------------------|---------|-----------------------|
| CONDUIT | | |
| WIRING | 12-7 | BOSNAK |
| FIXTURES | 3-9-56 | BOSNAK |
| POWER | | |
| UTILITY CO. NOTIFIED | 3-12-56 | Bosnak |
| FINAL | 3-12-56 | Bosnak |

I HEREBY ACKNOWLEDGE THAT I HAVE READ THIS APPLICATION AND STATE THAT THE ABOVE IS CORRECT AND AGREE TO COMPLY WITH ALL COUNTY ORDINANCES AND STATE LAWS REGULATING ELECTRICAL WIRING.

I HEREBY CERTIFY THAT I AM PROPERLY REGISTERED AND/OR LICENSED AS REQUIRED BY LOS ANGELES COUNTY AND STATE OF CALIFORNIA OR THAT I AM THE LEGAL OWNER OF THE ABOVE DESCRIBED RESIDENTIAL PROPERTY.

SIGNATURE OF PERMITTEE: *Jack Blevins*

WILLIAM J. FOX, COUNTY ENGINEER

VALIDATION

A. C. VEIT, CHIEF ELECT. INSPECTOR

7253R NOV 30 2 6.75
Bacon

Meter location

Service -

1" Ent.

3 #6 wire

50 amp. local.

~~F = 14 = 4 lights~~

~~2 #12 = 2 TRANS.~~

B = #12 = 5 plugs

C = #12 = 2 CHARGE DISC
+ 2 PLUGS + TRANS

50

12000
20

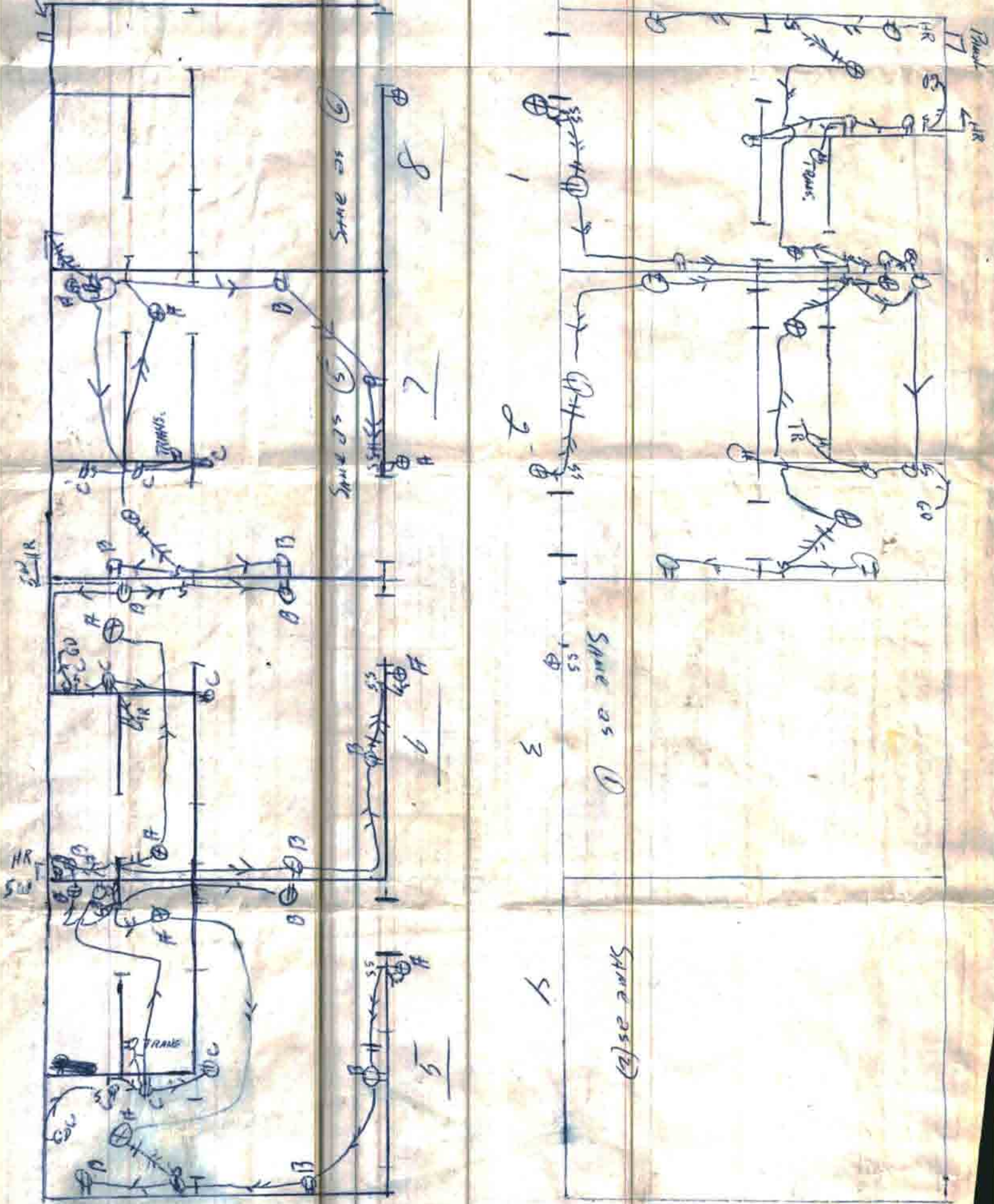

**BUILDING DEPARTMENT
ELECTRICAL INSPECTION
INGLEWOOD, CALIFORNIA**

**REPORT OF
ELECTRIC WIRING**

Permit No.

ELECTRICAL CONTRACTOR

OWNER

LOCATION

BETWEEN

ST.

AND

ST.

DATE PERMIT GRANTED

Fixtures Installed By

| NO. OF OUTLETS | NO. OF FIXTURES | MOTORS | |
|-------------------|--------------------|--------|-------|
| | | NUMBER | H. P. |
| | | | |
| | | | |
| | | | |

FIRST

INSPECTIONS

DATE

FINAL

Contractor's Phone