

15905 Prairie Ave.

FOR APPLICANT TO FILL IN	
BUILDING ADDRESS	1590 Prairie
LOCALITY	Laurel Dale
NEAREST CROSS ST.	159th
OWNER	Allen G. Carl
MAIL ADDRESS	15903 Prairie
CITY	Laurel Dale
ARCHITECT OR ENGINEER	TEL. NO. FR 4-7183
ADDRESS	
CONTRACTOR	TEL. NO.
ADDRESS	
LEGAL DESCRIPTION	LOT NO. 1684167 BLOCK
TRACT	7422
SIZE OF LOT	70x107 NO. OF BLDGS. NOW ON LOT 2
USE OF EXISTING BLDG.	RESID. & STORAGE NO. OF FAMILIES 1
DESCRIPTION OF WORK	
NEW	ALTERATION <input checked="" type="checkbox"/> ADDITION
REPAIR	DEMOLITION
SQ. FT. SIZE	NO. OF ROOMS
411	3 STORIES 1
EXT. WALL COVERING	ROOF COVERING
Stucco	Comp
USE OF STRUCTURE	
Convert Garage to Res.	
I HEREBY ACKNOWLEDGE THAT I HAVE READ THIS APPLICATION AND STATE THAT THE INFORMATION GIVEN IS CORRECT.	
I AGREE TO COMPLY WITH ALL COUNTY ORDINANCES AND STATE LAWS REGULATING BUILDING CONSTRUCTION.	
SIGNATURE OF PERMITTEE	Allen G. Carl
ADDRESS	15903 Prairie
AUTHORIZED AGT.	
\$	1000.00
VALUATION	
P. C. \$ FEE	
FEE	\$ 6.00

FOR OFFICE USE ONLY			
DISTRICT NO.	PLAN CK. OR REC. NO.	PERMIT NO.	
7		70456 B	
RECEIVED BY	DATE OF APPL.	DATE ISSUED	
Stokes	9/2/54	9/2/54	
BUILDING ADDRESS	15903 Prairie		
LOCALITY	Laurel Dale		
NEAREST CROSS ST.	159th		
FIRE ZONE	NO. OF PLANS	TYPE	GROUP
		F	F
BLDG. SETBACK LINE	ORD. NO.		
USE ZONE	APPROVED BY	DATE	
R-1			
HOUSE NUMBERING			
MAP NUMBER	NO. ASSIGNED BY		
4157			
CORRECTIONS			
<del>EXISTING IN CONCRETE</del>			
<del>159th</del>			
REFER TO PERM. # E51152 B			
ORIGINAL			
APPROVALS			
INSPECTOR'S SIGNATURE		DATE	
FOUNDATION; LOCATION FORMS, MATERIALS			
FRAME; FIRE STOPS, BRACING, BOLTS			
FURNACE; LOCATION, GAS VENT, DUCTS			
LATH, INT.			
LATH, EXT.			
PLASTER, INT.			
PLASTER, EXT.			
HOUSE NUMBER CORRECT AND POSTED			
FINAL			

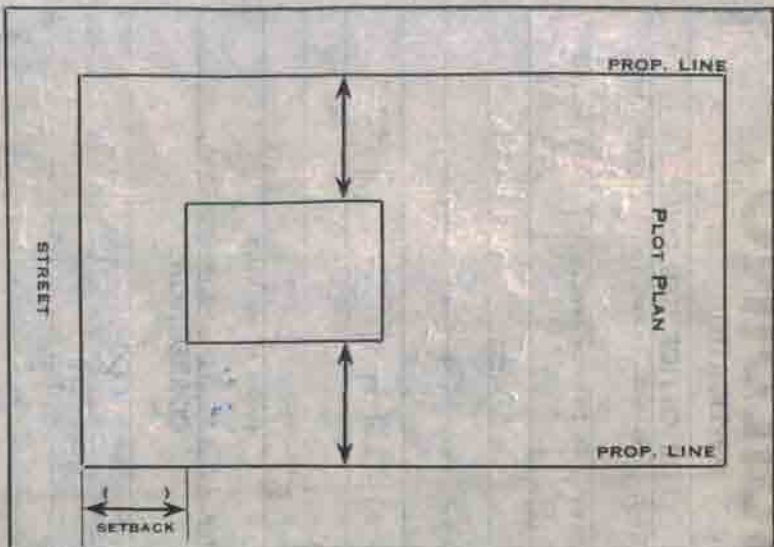

THIS PLAN IS THE PROPERTY OF THE  
 ARCHITECT AND IS NOT TO BE  
 REPRODUCED OR COPIED IN ANY  
 MANNER WITHOUT HIS WRITTEN  
 CONSENT.

ALL PARTS OF THIS PLAN TO BE  
 CONSIDERED AS ONE UNIT.

SHOW IN RED LINE

CONTRACT NO. 1000000000000000

DATE OF CONTRACT 10/10/2020

PROJECT NO. 1000000000000000

CLIENT NAME 1000000000000000

PROJECT ADDRESS 1000000000000000

PROJECT CITY 1000000000000000

PROJECT STATE 1000000000000000

PROJECT ZIP 1000000000000000

PROJECT PHONE 1000000000000000

PROJECT FAX 1000000000000000

PROJECT EMAIL 1000000000000000



WORKERS' COMPENSATION DECLARATION

I hereby affirm that I have a certificate of consent to self insure, or a certificate of Workers' Compensation Insurance, or a certified copy thereof (Sec. 3800, Lab. C.)

Policy No. \_\_\_\_\_ Company \_\_\_\_\_

- Certified copy is hereby furnished.
- Certified copy is filed with the county building inspection department.

Date \_\_\_\_\_ Applicant \_\_\_\_\_

CERTIFICATE OF EXEMPTION FROM WORKERS' COMPENSATION INSURANCE

(This section need not be completed if the work involved by the permit is for one hundred dollars (\$100) or less.)

I certify that in the performance of the work for which this permit is issued, I shall not employ any person in any manner so as to become subject to the Workers' Compensation Laws.

Date 6/23/81 Applicant L. Morgan

NOTICE TO APPLICANT: If, after making this Certificate of Exemption, you should become subject to the Workers' Compensation provisions of the Labor Code, you must forthwith comply with such provisions or this permit shall be deemed revoked.

LICENSED CONTRACTORS DECLARATION

I hereby affirm that I am licensed under provisions of Chapter 9 (commencing with Section 7000) of Division 3 of the Business and Professions Code, and my license is in full force and effect.

License Number 338705 Lic. Class C-10

Contractor Morgan Electric Date 6-23-81

HOME OWNER-BUILDER DECLARATION

I hereby affirm that I am exempt from the Contractor License Law for the following reason (Section 7031.7, Business and Professions Code):

- I, as owner of the property, will do the work and the structure is not intended or offered for sale (Section 7044, Business and Professions Code).

CONSTRUCTION LENDING AGENCY

I hereby affirm that there is a construction lending agency for the performance of the work for which this permit is issued (Sec. 3097, Civ. C.).

Lender's Name \_\_\_\_\_

Lender's Address None

I certify that I have read this application and state that the above information is correct. I agree to comply with all County ordinances and State laws regulating Electrical wiring, and hereby authorize representatives of this County to enter upon the above-mentioned property for inspection purposes.

Signature of Permittee L. Morgan Date 6/23/81

76A663  
CE-806G (2-80)

APPLICATION FOR ELECTRICAL PERMIT  
COUNTY OF LOS ANGELES

13903

BUILDING AND SAFETY

FIREWORK STAND

FOR APPLICANT TO FILL IN			JOB ADDRESS	
NEW RESIDENTIAL BLDGS. & POOLS	EACH	NO.		FEE
1 & 2-Family, Sq. Ft.	\$		\$	15800'S PRAIRIE
Multi-family Sq. Ft.				LOCALITY LAWNDALE
Residential Swimming Pools				NEAREST CROSS ST MANWATER AVENUE
Outlets: Rec. <u>1</u> Light <u>11</u> Sw. <u>11</u>				OWNER OR FIRM NAME
Total No. <u>11</u>			<u>.50 11 550</u>	MAIL ADDRESS
Lighting Fixtures				CITY _____ Tel No. _____
Total No. _____				PLAN CHECK APPLICANT
Fixed Appliances Not Over 1 HP				ADDRESS
Range _____ Heater _____ D.W. _____				CITY _____ Tel No. _____
Oven _____ Dryer _____ W.M. _____				PERMIT APPLICANT <u>Morgan Electric</u>
Top _____ FAU _____ W.H. _____				ADDRESS <u>4126 W. Compton Blvd</u>
Hood _____ Fan _____ Other _____				CITY <u>Lawndale</u> Tel No. <u>6448983</u>
Disp. _____ Room Air Cond. _____				LICENSE OR REG. NUMBER <u>338705</u> Class <u>C-10</u>
Power Apparatus & Large Appliances				DISTRICT NO. _____ PROCESSED BY _____
Size & Type HP, KW, KVA, or KVAR				7.01
Up to 1 Incl.				FINAL DATE _____ VALIDATION _____
Over 1 to 10 Incl.				FINAL BY _____
Over 10 to 50 Incl.				
Over 50 to 100 Incl.				
Over 100				
Services				
0-200 Amp. Under 600 V				
201-1000 Amp. Under 600 V				
Over 1000 Amp. or Over 600 V				
Temp. Power Pole & Appurtenances				
Sign with One Branch Circuit				
Additional Sign Branch Circuits				
Misc. Conduits & Conductors				
Other (See Complete Fee Schedule)				
PERMIT FEE (Sub-Total)			<u>7.00</u>	
PLAN CHECKING FEE (One-Fourth Permit Fee)				
PERMIT ISSUING FEE				
TOTAL FEE			<u>12.50</u>	

PERMITTEE COPY

3906A  
#...2  
1...1250  
...1250E  
0623-81

SPECIAL INFORMATION ON REVERSE SIDE

*WRKING*  
*Dr. Tom*

SEE REVERSE FOR EXPLANATORY LANGUAGE



COUNTY OF LOS ANGELES  
 Department of County Engineer  
 DIVISION OF BUILDING & SAFETY  
 WILLIAM J. FOX, County Engineer

APPLICATION FOR PERMIT

**ELECTRIC**

**1**

FOR APPLICANT TO FILL IN						DISTRICT NO.	GROUP	ZONE	PERMIT NO.
ELECTRICIAN						7	I	R-4	21749E
ADDRESS						RECEIVED BY	READY FOR FIRST INSPECTION	DATE ISSUED	
CITY						Stokes		9/21/54	
COUNTY LICENSE NO.						BUILDING ADDRESS			
EXPIRES						15905 Prairie			
PERMIT FEES						LOCALITY			
						Lawn Dale			
						NEAREST GROSS ST.			
						159 St			
						OWNER			
						Alvin G. Carl			
						MAIL ADDRESS			
						15903 Prairie			
						CITY			
						Lawn Dale			
						TEL. NO.			
						F.R. 4-7183			
						I HEREBY ACKNOWLEDGE THAT I HAVE READ THIS APPLICATION AND STATE THAT THE ABOVE IS CORRECT AND AGREE TO COMPLY WITH ALL COUNTY ORDINANCES AND STATE LAWS REGULATING ELECTRICAL WIRING.			
						I CERTIFY THAT I POSSESS THE ABOVE VALID LOS ANGELES COUNTY LICENSE, OR I AM THE LEGAL OWNER OF THE RESIDENTIAL PROPERTY DESCRIBED ABOVE.			
						SIGNATURE OF PERMITTEE			
						Mrs. Alvin Carl			
						INSPECTION RECORD			
						12-14-54			
						Working OK			
						Satisfactory			
						All work completed			
						5-1-55			
						Installation of wall plug			
						Approved			
						APPROVALS			
						DATE	INSPECTOR'S NAME		
						CONDUIT	6-11-55		
						WIRING	Boenke		
						FIXTURES	5/21/55		
						POWER	Vogel		
						UTILITY CO. NOTIFIED	6/1/55		
						FINAL	Vogel		
FOR EACH PERMIT:									
WIRING						\$1.00	1.00		
FIXTURES						\$1.00	1.00		
SUPPLEMENTARY						.50			
TOTAL FEE						\$	3.40		

ORIGINAL

1 Lt. new mts  
15905 Plover

1 gon  
1 Lt.  
15905 Plover

# BUILDING

## APPLICATION

### DIVISION OF BUILDING AND SAFETY

Department of County Engineer  
County of Los Angeles

WM. J. FOX, COUNTY ENGINEER  
CASSATT D. GRIFFIN, SUP'T OF BUILDING

### FOR APPLICANT TO FILL IN

OWNER	Allen & Carl		
MAIL ADDRESS	15903 Prairie		
CITY	Lanndale	TEL. NO.	704 7183
ARCHITECT OR ENGINEER	Owner		
ADDRESS	Owner		
CONTRACTOR	Owner		
ADDRESS	Owner		
BUILDING ADDRESS	15903 Prairie		
LOT NO.	1687167	BLOCK	
TRACT	7422		
SIZE OF LOT	70x107	NO. OF BLDGS. NOW ON LOT	2
USE OF EXISTING BLDG.	residence		

### DESCRIPTION OF WORK

NEW	ADD	ALTER	REPAIR	DEMOLISH
SQ. FT. SIZE	72'	NO. OF STORIES		NO. OF FAMILIES
USE OF STRUCTURE				

Owners Residence  
Closet & porch  
stucco exterior entire  
slightly add bath

NO. OF EMPLOYEES	
------------------	--

I HEREBY ACKNOWLEDGE THAT I HAVE READ THIS APPLICATION AND STATE THAT THE INFORMATION GIVEN IS CORRECT.

I AGREE TO COMPLY WITH ALL COUNTY ORDINANCES AND STATE LAWS REGULATING BUILDING CONSTRUCTION.

SIGNATURE OF PERMITTEE *Allen & Carl*

ADDRESS *15903 Prairie*

AUTHORIZED AGT.

\$	800 <sup>00</sup>
VALUATION	
P. C. \$ FEE	6 <sup>00</sup>
\$ FEE	

BUILDING ADDRESS	15903 5 PRAIRIE AVE		
LOCALITY	LANNDALE		
NEAREST CROSS ST.	159		
DISTRICT NO.	7	RECEIPT NO.	
GROUP	I	DATE RECEIVED	
TYPE CONST.	II	RECEIVED BY	
PERMIT NO.	E 51152 B		
DATE ISSUED	3-24-54		
ISSUED BY	<i>[Signature]</i>		

MAP NUMBER	4157	STATE HWY	YES	NO
USE ZONE	R4	SPECIAL CONDITIONS		
BUILDING SETBACK	YARD	HWY	STREET NAME	EXIST. WIDTH
FRONT P. L.		50'	PRAIRIE	80
SIDE P. L.				

DATE	CORRECTIONS	INSPECTOR
	02-25-54	
	Permit req to correct garage to dwelling	
	11 1/2 ft	
	* 12 x 12 footing	
	req	
	12x8 studs 16 OC, OK	
	Brace roof & stringer	
	over LR. Under	
	* Clear wall head over	
	12" OK to cover	

APPROVALS	INSPECTOR'S SIGNATURE	DATE
FOUNDATION: LOCATION FORMS, MATERIALS	<i>[Signature]</i>	1-18-50
FRAME: FIRE STOPS, BRACING, BOLTS	<i>[Signature]</i>	1-18-50
FURNACE: LOCATION, GAS VENT, DUCTS	<i>[Signature]</i>	1-18-50
LATH, INT.	<i>[Signature]</i>	1-18-50
LATH, EXT.	<i>[Signature]</i>	1-18-50
HOUSE NUMBER CORRECT AND POSTED	<i>[Signature]</i>	5/31/55
FINAL	<i>[Signature]</i>	6/1/55

ORIGINAL



