

15621 Prairie Ave.

APPLICATION FOR BUILDING PERMIT

1

DIVISION OF BUILDING AND SAFETY

Department of County Engineer
County of Los Angeles

WM. J. FOX, COUNTY ENGINEER
CASSATT D. GRIFFIN, SUPT OF BUILDING

FOR APPLICANT TO FILL IN

BUILDING ADDRESS 15621 S. PRAIRIE
LOT NO. SEE ATTACHED BLOCK 21
TRACT Redondo Ford Co.
SIZE OF LOT 52.50 x 101 **NO. OF BLDGS. NOW ON LOT** 1
USE OF EXISTING BLDG.

OWNER ANNA OLIVIA
MAIL ADDRESS 11030 BUFORD
CITY INGLEWOOD **TEL. NO.** OR2-7572
ARCHITECT OR ENGINEER L.C. MATOR **TEL. NO.** TO2-8177
ADDRESS 11015 PARAMOUNT, DOWNEY
CONTRACTOR PAT A. OLIVIA **TEL. NO.** DA9-6371
ADDRESS 15401 S. WESTERN GARDEN

DESCRIPTION OF WORK PLAN 1

NEW <input checked="" type="checkbox"/>	ADD	ALTER	REPAIR	DEMOLISH
SQ. FT. SIZE	1982	NO. OF STORIES	1	NO. OF FAMILIES
USE OF STRUCTURE	RESIDENCE			

\$ ATTACHED GARAGE 18x22
SIGNATURE OF APPLICANT Anna Olivia
ADDRESS 11030 BUFORD, INGLEWOOD

\$ VALUATION 11700.00
P.C. FEE \$ 1400
FEE \$ 2800

I HEREBY ACKNOWLEDGE THAT I HAVE READ THIS APPLICATION AND STATE THAT THE ABOVE IS CORRECT AND AGREE TO COMPLY WITH ALL COUNTY ORDINANCES AND STATE LAWS REGULATING BUILDING CONSTRUCTION.

SIGNATURE OF PERMITTEE Pat A. Olivia
ADDRESS 15401 S. WESTERN

BUILDING ADDRESS 15621 S. PRAIRIE
LOCALITY LAWYDALE
NEAREST CROSS ST. MANHATTAN BCK BLVD
DISTRICT NO. 7 **GROUP** IAJ **TYPE** V **SEWER** BK M **MAP** PG 122
MAP NUMBER 41.56 **STATE HWY** YES NO
USE ZONE H1 **SPECIAL CONDITIONS** S
BUILDING SETBACK FRONT P.L. 50' & S. PRAIRIE
SIDE P.L.

- | | | | |
|---|---------------|---|-------------------|
| 1 | DWELL. 1 UNIT | 5 | INDUSTRIAL |
| 2 | DUPLEX UNIT | 6 | PUBLIC BLDG. |
| 3 | APT. UNITS | 7 | ADDN., ALT., ETC. |
| 4 | COMMERCIAL | 8 | MISCEL. |

INSPECTION RECORD

7500
 No Plans on job
 Basmat
 OK to start Basmat
 [Signature]

APPROVALS

DATE	INSPECTOR'S SIGNATURE
3-4-55	Basmat
4-6-55	Basmat
4-20-55	Basmat
5-16-55	Basmat
3-27-56	Stall

VALIDATION

BY AC 7549R JUN 14 1956
 DEPUTY

14.000 \$ BY 7 OR JUN 22 1956 28.00
 DEPUTY [Signature]

BY DEPUTY DEPUTY

240 / 510.0
84
220

240

CITY OF LAWDALE

APPLICATION FOR OCCUPANCY INSPECTION

1

FOR APPLICANT TO FILL IN (Print or type only)

COUNTY OF LOS ANGELES
DEPARTMENT OF COUNTY ENGINEER
BUILDING AND SAFETY DIVISION

BUILDING ADDRESS 15621 PRAIRIE AVE.	
CITY LAWDALE	ZIP 90505
SIZE OF LOT 300' x 21' (52.5 x 105.5)	
NO. OF BLDGS. ON LOT 3	
TRACE T. 3 S. R. 14 W	
OWNER ROBERT HIYANE	TEL. NO. 676 2609
ADDRESS 15621 PRAIRIE AVE	
CITY LAWDALE	ZIP 90505
SIZE OF EXISTING BLDG. 1200 SQ. FT.	NO. OF STORIES 1
PRESENT USE OF BUILDING SINGLE FAMILY RESIDENCE	
NO. PARKING SPACES PROVIDED 2 CAR GARAGE ATTACHED	
REASON FOR INSPECTION REQUEST TO CHECK COVERED PATIO	
PROPOSED MAX. OCC. 3	
I HEREBY ACKNOWLEDGE THAT I HAVE READ THIS APPLICATION AND STATE THAT THE ABOVE IS CORRECT.	
SIGNATURE OF APPLICANT Wayne E. Marshall	
ADDRESS 22704 MAPLE AVE. TORRANCE	
ZIP 90505	
PHONE 326-1826	
MAKE CHECKS PAYABLE TO: HARVEY T. BRANDT, COUNTY ENGINEER	

BUILDING ADDRESS 15621 S. Prairie	
LOCALITY LAWDALE	
NEAREST CROSS ST.	
ASSESSOR MAP BOOK	PAGE
DISTRICT 7.00	TYPE CONST. V
FIRE ZONE 3	PROCESSED BY Boak
USE ZONE R-1	MAP NO. 4156
SPECIAL CONDITIONS	
BLDG. SETBACK FROM FRONT PROP. LINE OF PRAIRIE (STREET)	
HIGHWAY + YARD =	TOTAL SETBACK FROM FRONT PROP. LINE
0 + 20 =	20'
TYPE OF EXISTING HIGHWAY WIDTH MAT 142	
BLDG. SETBACK FROM SIDE PROP. LINE OF _____ (STREET)	
HIGHWAY + YARD =	TOTAL SETBACK FROM SIDE PROP. LINE
+ =	
TYPE OF EXISTING HIGHWAY WIDTH	
CORNER CUTOFF	YES NO
OCCUPANCY GROUP AS VERIFIED	OCCUPANT LOAD
NO. OF EXITS	EXIT HARDWARE:
	NO SPEC. KNOWL. <input type="checkbox"/>
	PANIC DEVICES <input type="checkbox"/>
PARKING SPACES	REQ'D PROVIDED
Patio Cover removed 4/26/74 Boak	
FINAL DATE	BY

INSPECTOR COPY

APPLICATION VALIDATION CK. M.O. CASH

LAC 085974 APR 24 22 18.00

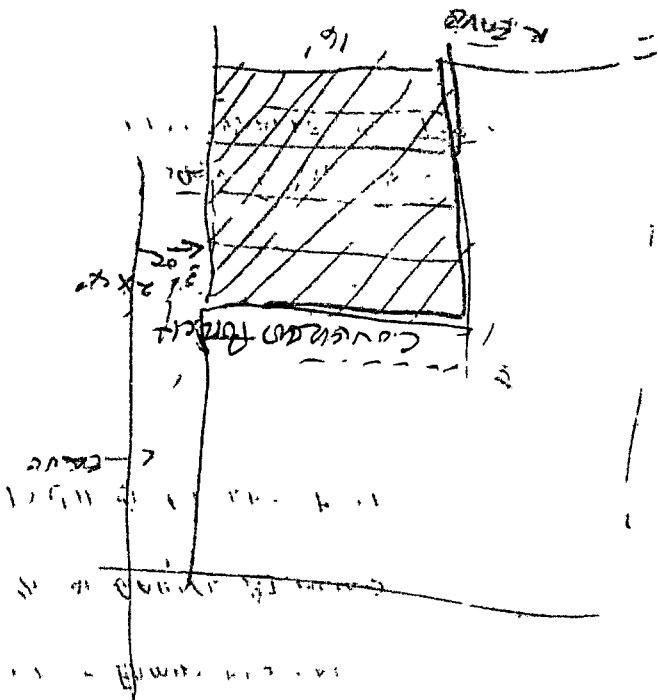

APPLICATION FOR PERMIT SEWER-SEWAGE DISPOSAL

DIVISION OF BUILDING AND SAFETY

Department of County Engineer
County of Los Angeles

WM. J. FOX, COUNTY ENGINEER

CASSATT D. GRIFFIN, SUPT OF BUILDING

FOR APPLICANT TO FILL IN

LEGAL DESCRIPTION	LOT NO. <i>SEE legal in Bldg</i>		
BLOCK	TRACT <i>Dept. Office</i>		
SIZE OF LOT	<i>52x101</i>	NO. OF BLDGS, NOW ON LOT	<i>1</i>
USE OF BUILDINGS	<i>Dwell</i>		
CONTRACTOR	<i>N.A. Artukovich Const. Co.</i>		
ADDRESS	<i>723 Union St.</i>		
CITY	<i>Montebello</i>	TEL. NO.	
REGISTRATION NO.	<i>115917</i>	<input checked="" type="checkbox"/> STATE <input type="checkbox"/> COUNTY	<i>CA 2</i>

NO.	DESCRIPTION OF WORK	FEE	
<i>1</i>	HOUSE SEWER CONNECTING TO PUBLIC SEWER	@ \$ 3.50	<i>350</i>
	HOUSE SEWER CONNECTING TO PRIVATE DISPOSAL SYSTEM	1.00	
	CONNECT ADDITIONAL BLDG. OR WORK TO HOUSE SEWER	1.00	
	ALTER OR REPAIR EXISTING SEWER OR DISPOSAL SYSTEM	1.00	
	DISCONNECT AND ABANDON SEWER AND/OR DISPOSAL SYSTEM	1.00	
	SEPTIC TANK, SEEPAGE PIT OR PITS AND/OR DRAINFIELD	2.00	
	CESSPOOL - DRYWELL	2.00	
	SPECIAL CONDITIONS ONLY	2.00	

OWNER'S AUTHORIZATION	PERMIT	\$	<i>1</i>	00
	TOTAL FEE		<i>4.50</i>	

I HAVE THIS DATE CONTRACTED WITH THE HEREIN NAMED CONTRACTOR TO CONNECT THE ABOVE DESCRIBED EXISTING DWELLING TO THE PUBLIC SEWER

SIGNED THIS _____ DAY OF _____ 19____

OWNER OR OWNERS' AGENT _____
ADDRESS _____

I HEREBY ACKNOWLEDGE THAT I HAVE READ THIS APPLICATION AND STATE THAT THE ABOVE IS CORRECT AND AGREE TO COMPLY WITH ALL COUNTY ORDINANCES AND STATE LAWS REGULATING PLUMBING AND SEWERS.

I HEREBY CERTIFY THAT I AM PROPERLY REGISTERED AND/OR LICENSED AS REQUIRED BY LOS ANGELES COUNTY AND STATE OF CALIFORNIA OR THAT I AM THE LEGAL OWNER OF THE ABOVE DESCRIBED RESIDENTIAL PROPERTY.

SIGNATURE OF PERMITTEE *N.A. Artukovich*

BUILDING ADDRESS	<i>15621 1/2 PRAIRIE AVE</i>	
LOCALITY	<i>Lawndale</i>	
NEAREST CROSS ST.	<i>Manhattan Bch Blvd.</i>	
OWNER	<i>T-J- Const. Co.</i>	
MAIL ADDRESS	<i>15401 So. WESTERN</i>	
CITY	<i>Garbana</i>	TEL. NO.

DISTRICT NO. <i>7</i>	GROUP <i>I</i>	BK MAP PG <i>NON INDEX</i>
--------------------------	-------------------	-------------------------------

CONNECTION DATA	
STATION <i>2+46.5</i>	DEPTH <i>5</i>
MANHOLE REFERENCE UPPER	<i>46.5 N/A</i> LOWER
TYPE OF CONNECTION CURB	LENGTH FROM M.L. TO P.L. <i>3</i>

CO. IMP. NO. _____	JOB NO. _____
TRUNK PERMIT NO. _____	ROAD PERMIT NO. <i>PC-3610</i>
STATE ENCROACHMENT PERMIT NO. _____	
INDUSTRIAL WASTE APPROVAL _____	

CHARGES
CONNECTION CHARGE FEE
REIMBURSEMENT FEE

APPROVALS	DATE	INSPECTOR'S SIGNATURE
NEW HOUSE SEWER	<i>11-29-55</i>	<i>C. Griffin</i>
CONNECT ADDITIONAL BUILDING OR WORK		
SEPTIC TANK, SEEP. PIT(S) AND/OR DRAINFIELD		
CESSPOOL <input type="checkbox"/> DRYWELL <input type="checkbox"/>		
ALTER, REPAIR, SEWER OR SEWAGE DISPOSAL SYSTEM		
DISCONNECT PLUG AND ABANDON HOUSE SEWER		
BACKFILL SEPTIC TANKS <input type="checkbox"/> SEEP. PIT(S) <input type="checkbox"/> CESSPOOLS <input type="checkbox"/>		

WILLIAM J. FOX, COUNTY ENGINEER

VALIDATION

BY _____
DEPUTY

BY _____
DEPUTY

6687187 NO. 22 4

4.50
DEPUTY

W. J. Fox

BY _____
DEPUTY

REQUIRED INFORMATION

1. INDICATE ALL BUILDINGS ON PROPERTY.
2. INDICATE AND DIMENSION SEWAGE DISPOSAL SYSTEM WITH TIE DISTANCES TO BUILDINGS AND PROPERTY LINES.
3. INDICATE SIZE OF SEPTIC TANK—DEPTH OF SEEPAGE PIT(S)—SIZE OF CESSPOOL(S)
4. INDICATE NORTH DIRECTION ON PLOT.
5. INDICATE BOTH STREETS IF CORNER.

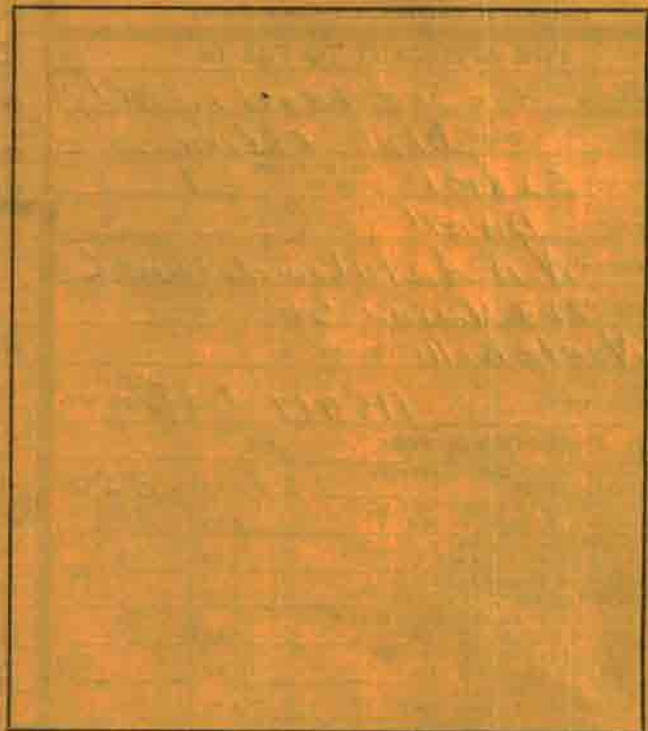

ST. ALLEY R/W

FIELD NOTES

Field notes section consisting of multiple horizontal lines for writing.



CITY OF LAWDALE
COUNTY OF LOS ANGELES
DEPARTMENT OF
PUBLIC WORKS BUILDING AND SAFETY
DIVISION



14717 BURIN AVENUE
 LAWDALE, CA 90260
 PH: (310) 973-3236

Mechanical Permit
PERMIT NUMBER:
PR20130000976

LEGAL ID: *LAND DESC IN DOC 0002358,760603*TR=PARTITION MAP SHOWING PROPERTY FORMERLY OF THE REDONDO LAND CO*POR OF LOT 15 IN SEC 21 T 3S R 14W	DESCRIPTION WORK ITEMS: Qty: UoM: Amt. Tot. Furnace (up to 100,000 BTU) 1.00 Each 32.70 32.70		BUILDING ADDRESS: 15621 PRAIRIE AVE LAWDALE CA 90260				
	FEES: Amt. Issuance Fee 33.60 Furnace (up to 100,000 BTU) 32.70 TOTAL FEES PAID: 66.30		PROCESSED BY: CCorea PC.SUBMITAL ISSUED ON: 26 Nov 2013 EXPIRES ON: 25 May 2014				
ASSESSOR INFORMATION NUMBER: 4076023017			FINAL DATE: 1/7/14		FINAL BY: [Signature]		
OWNER: DIAZ, JOE C AND ALICE I 15621 PRAIRIE AVE LAWDALE, CA 90260	TEL. NO:			USE ZONE: R-1	GROUP: R-3	CONST. TYPE: V-B	
				DIST: 7.01	FIRE ZONE: 3		
APPLICANT:	TEL. NO:			STATISTICAL CLASSIFICATION: DESCRIPTION OF WORK: Replace furnace 70K BTU SPECIAL CONDITIONS:			
CONTRACTOR: COLE SERVICES 10652 TRASK AVE GARDEN GROVE, CA 92843	TEL. NO: (800) 563-7757			APPROVAL	DATE	INSPECTOR	
LICENCE NO: C 20-718978				Rough			
ARCHITECT OR ENGINEER:	TEL. NO:			FINAL			
LICENCE NO:							
LEAD HAZARD WARNING: Due to the possible presence of lead-based paint, lead-safe work practices are required for all repairs that disturb paint in pre-1979 buildings. Failure to do so could create lead hazards that violate California Health and Safety Code, Sections 17920.10 and 105256 with potential fines for violations up to \$5,000 (Section [d] amended) or imprisonment for not more than 6 months in the county jail or both. For more information call 1-800-LA-4-LEAD.							

INSPECTOR COPY

THIS PERMIT WILL EXPIRE IF CONSTRUCTION IS NOT STARTED WITHIN SIX (6) MONTHS OF THE DATE APPROVED BY THE BUILDING OFFICIAL. CONSTRUCTION ACTIVITY MAY BE CONDUCTED BETWEEN THE HOURS OF 7 A.M. AND 7 P.M., MONDAY THROUGH FRIDAY (EXCEPT NATIONAL HOLIDAYS), AND 8 A.M. AND 5 P.M. SATURDAYS. CONSTRUCTION ACTIVITY IS PROHIBITED AT ALL OTHER HOURS AND ON SUNDAYS AND NATIONAL HOLIDAYS. Printed on: 26 Nov 2013

APPLICATION FOR PLUMBING PERMIT

1

DIVISION OF BUILDING AND SAFETY

Department of County Engineer
County of Los Angeles

WM. J. FOX, COUNTY ENGINEER
CASSATT D. GRIFFIN, SUP'Y OF BUILDING

FOR APPLICANT TO FILL IN

OWNER *Chivia Court Co*
MAIL ADDRESS
CITY TEL. NO.
PLUMBER *Morgan Bell*
ADDRESS *4500 Manhattan Beach Blvd*
CITY *Laundale* TEL. NO. *FA 47819*
LICENSE NO. *115179 C36*

NUMBER	TYPE OF FIXTURE OR ITEM	FEE
2	WATER CLOSET (TOILET)	\$
1	BATH TUB	
1	SHOWER	
2	LAVATORY (WASH BASIN)	
1	KITCHEN SINK	
	DISHWASHER	
1	LAUNDRY TUB OR TRAY	
	CLOTHES WASHER	
8	TOTAL NO.	@ 0.80 6.40
1	GAS SYSTEM 4 OUTLETS	@ 1.00 1.00
1	WATER HEATER	@ 1.00 1.00
	PERMIT	\$ 1.00
	TOTAL FEE	9.40

I HEREBY ACKNOWLEDGE THAT I HAVE READ THIS APPLICATION AND STATE THAT THE ABOVE IS CORRECT AND AGREE TO COMPLY WITH ALL COUNTY ORDINANCES AND STATE LAWS REGULATING PLUMBING.

I HEREBY CERTIFY THAT I AM PROPERLY REGISTERED AND/OR LICENSED AS REQUIRED BY LOS ANGELES COUNTY AND STATE OF CALIFORNIA OR THAT I AM THE LEGAL OWNER OF THE ABOVE DESCRIBED RESIDENTIAL PROPERTY.

SIGNATURE OF PERMITTEE *Clayton Morgan*

BUILDING ADDRESS *15621 Prairie*
LOCALITY *Laundale*
NEAREST CROSS ST. *Manhattan Beach Blvd*

DISTRICT NO. <i>7</i>	GROUP <i>I</i>	ZONE <i>A1</i>	READY FOR INSPECTION
-----------------------	----------------	----------------	----------------------

INDUSTRIAL WASTE APPROVAL

INSPECTION RECORD

*D leak in sinks for 3/4 bath
show stub 92-50 Bosmol
10-17 (Bosmol) N6 Bosmol*

APPROVALS

	DATE	INSPECTOR'S SIGNATURE
UNDER SLAB WORK		
ROUGH PLUMBING		
GAS PIPING		
GAS VENT		
HOT WATER HEATER		
PLUMBING FIXTURES		
GAS TEST	<i>10-19-85</i>	<i>Bosmol</i>
UTILITY CO. NOTIFIED	<i>10-20-85</i>	<i>Bosmol</i>
FINAL	<i>10-21-85</i>	<i>Stall</i>

WILLIAM J. FOX, COUNTY ENGINEER

VALIDATION

ACo 2361R A031 3 9.40

BY

Bacon DEPUTY

15621 S. Prairie

ADRY RARE

PATIO COVER SUPPORTS
CONNECTIONS TO EXISTING
BUILDING AND FRAMING
MEMBERS ARE NOT
ADEQUATE

REMOVE OR REBUILD
PER CODE,

4/25/74

Cook

TYPICAL PATIO COVER DETAIL
AVAILABLE AT CITY HALL

PLAN - 1

- A #12 = 9 OUTLETS
- B #12 = 5 " + FAN
- C #12 = 8 "
- D #12 = 1 " + 1/4 DISPOSAL
- E #14 = 1 16 LIGHTS
- F #14 = 1 1Kw HEATER
- G #14 = " "

