

4719 West 152nd Street



APPLICATION FOR BUILDING PERMIT

Bus Lic# 02999

COUNTY OF LOS ANGELES

BUILDING AND SAFETY

WORKER'S COMPENSATION DECLARATION

I hereby affirm that I have a certificate of consent to self insure, or a certificate of Workers Compensation Insurance, or a certified copy thereof (Sec. 3800, Lab. C.)

Policy No. _____ Company _____

- Certified copy is hereby furnished.
- Certified copy is filed with the county building inspection department.

Date _____ Applicant _____

CERTIFICATE OF EXEMPTION FROM WORKERS' COMPENSATION INSURANCE

(This section need not be completed if the permit is for one hundred dollars (\$100) or less.)

I certify that in the performance of the work for which this permit is issued, I shall not employ any person in any manner so as to become subject to the Workers' Compensation Laws.

Date _____ Applicant _____

NOTICE TO APPLICANT: If, after making this Certificate of Exemption, you should become subject to the Workers' Compensation provisions of the Labor Code, you must forthwith comply with such provisions or this permit shall be deemed revoked.

LICENSED CONTRACTORS DECLARATION

I hereby affirm that I am licensed under provisions of Chapter 9 (commencing with Section 7000) of Division 3 of the Business and Professions Code, and my license is in full force and effect.

License Number _____ Lic. Class _____

Contractor _____ Date _____

- I am exempt under Sec. _____

B. & P.C. for this reason _____

Date: _____

Signature _____

- I, as owner of the property, or my employees with wages as their sole compensation, will do the work and the structure is not intended of offered for sale (Section 7044, Business and Professions Code.)

- I, as owner of the property, am exclusively contracting with licensed contractors to construct the project (Section 7044, Business and Professions Code.)

CONSTRUCTION LENDING AGENCY

I hereby affirm that there is a construction lending agency for the performance of the work for which this permit is issued (Sec. 3097, Civ. C.)

Lender's Name _____

Lender's Address _____

I certify that I have read this application and state under penalty of perjury that the above information is correct. I agree to comply with all county ordinances and State laws relating to building construction, and hereby authorize representatives of this County to enter upon the above-mentioned property for inspection purposes.

Signature of Applicant or Agent

Date

FOR APPLICANT TO FILL IN

BUILDING ADDRESS 4719 W. 152nd ST.		
CITY LAWRENDALE	ZIP	
SIZE OF LOT	NO. OF BLDGS. NOW ON LOT	
TRACT	BLOCK	LOT NO.
ASSESSOR MAP BOOK	PAGE	PARCEL
OWNER CHRIS HERRERA	TEL NO. 310/676-9429	
ADDRESS 4522 BELLEVUE BAY AV.	(702) 431-6073	
CITY LAS VEGAS NV.	ZIP 89142	
ARCHITECT OR ENGINEER	TEL NO.	
ADDRESS		
CONTRACTOR MUTUAL ROOFING CO. INC.	TEL NO. 310/327-2263	
ADDRESS 436 W. 118th ST.	LIC. NO. 442500	
CITY GARDENA CA	LIC. CLASS C-39	
SQ. FT. SIZE	NO. OF STORIES	NO. OF FAMILIES
DESCRIPTION OF WORK REMOVE EXISTING ROOFING TO SHEETING INSTALL 3-TAB CLASS A COMP.		
USE OF EXISTING BLDG.		
APPLICANT (PRINT) GLENODELL	TEL NO. 310/532-5410	
ADDRESS 425 W 118th ST. GARDENA CA		
WILL THE APPLICANT OR FUTURE BUILDING OCCUPANT HANDLE A HAZARDOUS MATERIAL OR A MIXTURE CONTAINING A HAZARDOUS MATERIAL EQUAL TO OR GREATER THAN THE AMOUNTS SPECIFIED ON THE HAZARDOUS MATERIALS INFORMATION GUIDE? YES <input type="checkbox"/> NO <input checked="" type="checkbox"/>		
WILL THE INTENDED USE OF THE BUILDING BY THE APPLICANT OR FUTURE BUILDING OCCUPANT REQUIRE A PERMIT FOR CONSTRUCTION OR MODIFICATION FROM THE SOUTH COAST AIR QUALITY MANAGEMENT DISTRICT (SCAQMD) SEE PERMITTING CHECKLIST FOR GUIDELINES. YES <input type="checkbox"/> NO <input checked="" type="checkbox"/>		
I HAVE READ THE HAZARDOUS MATERIALS INFORMATION GUIDE AND THE SCAQMD PERMITTING CHECKLIST. I UNDERSTAND MY REQUIREMENTS UNDER THE LOS ANGELES COUNTY CODE, TITLE 2, CHAPTER 220 SECTIONS 2.20.100 THROUGH 2.20.140 CONCERNING HAZARDOUS MATERIALS. I AGREE TO OBTAINING A PERMIT FROM THE SCAQMD. <i>[Signature]</i>		
OWNER OR AGENT		
P.C. FEE	PERMIT FEE	71.47
	ISSUANCE FEE	21.95
INVESTIGATION FEE	ISSUANCE FEE	93.47

BUILDING ADDRESS 4719 W. 152nd ST.

LOCALITY Lawndale Ca 90260

NEAREST CROSS ST.

USE ZONE R-2 MAP NO. SPECIAL CONDITIONS

WITHIN 1000 FT. OF SCHOOL? YES NO

DISTRICT 7.01 GROUP R-2 TYPE CONST. FIRE ZONE PROCESSED BY [Signature]

STATISTICAL CLASSIFICATION CLASS NO. DWELL UNITS APT CONDO

REQUIRED SETBACK	YARD	HWY	TOTAL SETBACK FROM PROP LINE	EXIST WIDTH
FRONT				
P L				
SIDE				
P L				

SEWER MAP BK PG

VALUATION \$ 2100 -

\$

LDMA P/C #

LDMA PERM #

FINAL DATE 5-15-02

FINAL BY [Signature]

VALIDATION

#1
01* *9347
*9347
12 1 ***E
22448
14-49
05-06-02
20

INSPECTOR COPY

PLANS TO APPLICANT

INSPECTOR'S NOTES

To.		Returned		Approved
No.	Date	No.	Date	

Approvals	Required		Date Received or Approved
	Yes	No	
Water Certificate			
Health Department			
Fire Department			
Grading			
Geological			
Pedestrian Protection (Fence) (Canopy)			
Special Inspection (Conc.) (Masonry) (Welding)			
Lot Drainage			
Parking			

Approvals	Date	Inspector's Signature
Location (Setback & Yards)		
Foundations		
Stab		
Frame		
Energy Insulation		
Lath/Drywall-Interior		
Lath-Exterior		
House Number-Correct & Posted		
Final Enter on Front		
Certificate of Occupancy Issued		
Sheathing	5-8-02	R. Bourne

[Handwritten notes in the Inspector's Notes column, including dates and signatures.]

OWNER-BUILDER DECLARATION

I hereby affirm that I am exempt from the Contractor's License Law for the following reason. (Sec. 7031.5) *Business and Professions Code: Any city or county which requires a permit to construct, alter, improve, demolish, or repair any structure, prior to its issuance, also requires the applicant for such permit to file a signed statement that he is licensed pursuant to the provisions of the Contractor's License Law (Chapter 9) (commencing with Section 7000 of Division 3 of the Business and Professions Code) or that he is exempt therefrom and the basis for the alleged exemption. Any violation of Section 7031.5 by any applicant for a permit subjects the applicant to a civil penalty of not more than five hundred dollars (\$500).:*

I, as owner of the property, or my employees with wages as their sole compensation, will do the work, and the structure is not intended or offered for sale (Sec. 7044) *Business and Professions Code: The Contractor's License Law does not apply to an owner-of-property who builds or improves thereon, and who does such work himself or through his own employees, provided that such improvements are not intended or offered for sale. If, however, the building or improvement is sold within one year of completion, the owner-builder will have the burden of proving that he did not build or improve for the purpose of sale.*

I, as owner of the property, am exclusively contracting with licensed contractors to construct the project (Sec. 7044) *Business and Professions Code: The Contractor's License Law does not apply to an owner of property who builds or improves thereon, and who contracts for such projects with a contractor(s) licensed pursuant to the Contractor's License laws.*

I am exempt under Sec. _____, B. & P.C. for this reason _____
Date _____ Owner _____

INSPECTOR'S NOTES

[Blank lines for Inspector's Notes.]

76A642D
8 & E-663 11-55

APPLICATION FOR PERMIT SEWER—SEWAGE DISPOSAL

1

DIVISION OF BUILDING AND SAFETY
Department of County Engineer
County of Los Angeles
JOHN A. LAMBIE, COUNTY ENGINEER
CASSATT D. GRIFFIN, SUPT OF BUILDING

BUILDING ADDRESS	4719 West 152nd St.
LOCALITY	Lawndale
NEAREST CROSS ST.	Condon
OWNER	Willie Wilson
MAIL ADDRESS	
CITY	TEL. NO. OS 60188

FOR APPLICANT TO FILL IN			
LEGAL DESCRIPTION	LOT NO. 26		
BLOCK	TRACT 6578		
SIZE OF LOT	NO. OF BLDGS. NOW ON LOT 1		
USE OF BUILDINGS	Home		
CONTRACTOR	Anderson & Sons		
ADDRESS	11033 Hawthorne Blvd.		
CITY	Inglewood	TEL. NO.	OR 8 4344
REGISTRATION NO.	C-42 134276	<input type="checkbox"/> STATE <input checked="" type="checkbox"/> COUNTY	
NO.	DESCRIPTION OF WORK	FEE	
1	HOUSE SEWER CONNECTING TO PUBLIC SEWER	@ \$3.50	3.50
	SEPTIC TANK, SEEPAGE PIT OR PITS AND/OR DRAINFIELD	@ \$3.00	
	OVERFLOW SEEPAGE PIT, DRAINFIELD EXTN., CESSPOOL, DRYWELL, MANHOLE	@ \$2.00	
	HOUSE SEWER CONNECTING TO PRIVATE DISPOSAL SYSTEM	@ \$1.00	
	CONNECT ADDITIONAL BLDG. OR WORK TO HOUSE SEWER	@ \$1.00	
	ALTER, REPAIR OR ABANDON HOUSE SEWER OR DISPOSAL SYSTEM	@ \$1.00	
OWNER'S AUTHORIZATION		PERMIT \$ 1.00	
		TOTAL FEE	4.50
I HAVE AT THIS DATE A CONTRACT WITH THE CONTRACTOR TO CONNECT THE ABOVE DESCRIBED TO THE PUBLIC SEWER. HEREIN NAMED CONTRACTOR EXISTING DWELLING			
SIGNED THIS 29 DAY OF Nov. 19 56			
OWNER OR OWNERS AGENT New			
ADDRESS			
I HEREBY ACKNOWLEDGE THAT I HAVE READ THIS APPLICATION AND STATE THAT THE ABOVE IS CORRECT AND AGREE TO COMPLY WITH ALL COUNTY ORDINANCES AND STATE LAWS REGULATING PLUMBING AND SEWERS.			
I HEREBY CERTIFY THAT I AM PROPERLY REGISTERED AND/OR LICENSED AS REQUIRED BY LOS ANGELES COUNTY AND STATE OF CALIFORNIA OR THAT I AM THE LEGAL OWNER OF THE ABOVE DESCRIBED RESIDENTIAL PROPERTY.			
SIGNATURE OF PERMITTEE		<i>Rene L. Anderson</i>	

DISTRICT NO.	7	GROUP	T	MAP BK PG	M-177
CONNECTION DATA					
STATION	3+15	DEPTH	8'		
MANHOLE REFERENCE	5570	SE		<input checked="" type="checkbox"/> UPPER <input type="checkbox"/> LOWER	
Y. TYPE OF CONNECTION CURB		P.L.		LENGTH FROM M.L. TO P.L. 27	
CO. MP. NO.	1506	P. C. NO.	JOB NO.		
TRUNK PERMIT NO.	ROAD PERMIT NO.				
STATE ENCROACHMENT PERMIT NO.					
INDUSTRIAL WASTE APPROVAL					

CHARGES	
CONNECTION CHARGE FEE	
REIMBURSEMENT FEE	
APPROVALS	
NEW HOUSE SEWER	11/26/56 <i>Chambers</i>
CONNECT ADDITIONAL BUILDING OR WORK	
SEPTIC TANK, SEEP, PIT(S) AND/OR DRAINFIELD	
CESSPOOL <input type="checkbox"/> DRYWELL <input type="checkbox"/>	
ALTER, REPAIR, SEWER OR SEWAGE DISPOSAL SYSTEM	
DISCONNECT PLUG AND ABANDON HOUSE SEWER	
BACKFILL SEPTIC TANKS <input type="checkbox"/> SEEP, PIT(S) <input type="checkbox"/> CESSPOOLS <input type="checkbox"/>	
DATE	INSPECTOR'S SIGNATURE

JOHN A. LAMBIE, COUNTY ENGINEER VALIDATION ROBERT A. WOOD, CHIEF PLBG. INSPECTOR

CR. M. O. 1956

LAC 71938 NOV 29 4 4.50

G. Kelly

REQUIRED INFORMATION

1. INDICATE ALL BUILDINGS ON PROPERTY.
2. INDICATE AND DIMENSION SEWAGE DISPOSAL SYSTEM WITH THE DISTANCES TO BUILDINGS AND PROPERTY LINES.
3. INDICATE SIZE OF SEPTIC TANK—DEPTH OF SEEPAGE PIT(S)—SIZE OF CESSPOOL(S).
4. INDICATE NORTH DIRECTION ON PLOT.
5. INDICATE BOTH STREETS IF CORNER.

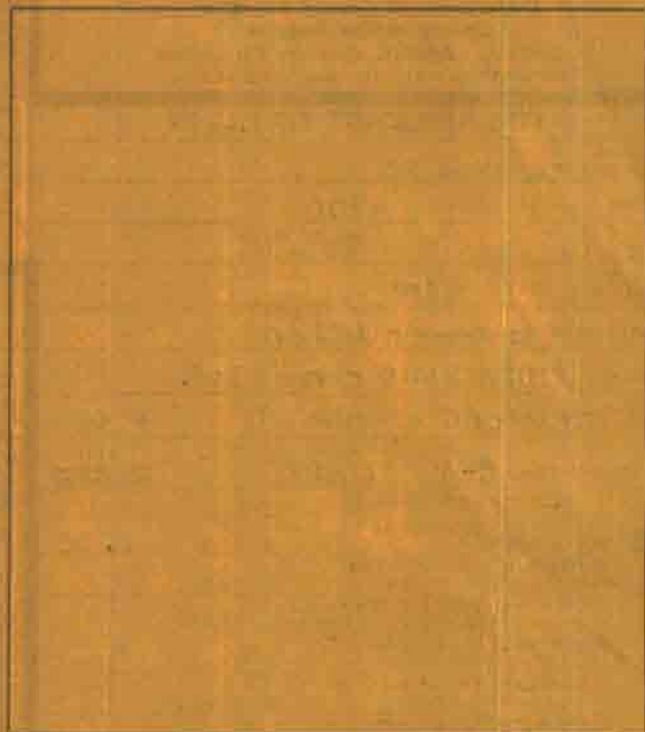

ST. ALLEY R/W

FIELD NOTES

12/13/56 Called for insp - sewer trench dug
but pipe not installed
Checked

APPLICATION FOR BUILDING PERMIT

DIVISION OF BUILDING AND SAFETY
 Department of County Engineer
 County of Los Angeles
JOHN A. LAMBIE, COUNTY ENGINEER
 CASSATT D. GRIFFIN, SUP'T OF BUILDING

BUILDING ADDRESS 4719 W. 152 ST
 LOCALITY Lawndale
 NEAREST CROSS ST. Inglewood

FOR APPLICANT TO FILL IN

DISTRICT NO. 7 GROUP I TYPE CONST. V SEWER MAP BK M-177 PG

BUILDING ADDRESS 4719 W. 152 ST

MAP NUMBER 4156 STATE HWY YES NO

LOT NO. 26 BLOCK

USE ZONE A-1 SPECIAL CONDITIONS 7 Hudgins

TRACT 6578

BUILDING SETBACK YARD HWY STREET NAME EXIST. WIDTH

SIZE OF LOT 31 X 150 NO. OF BLDGS. NOW ON LOT

FRONT P.L. 20' W. 152 ST 60

USE OF EXISTING BLDG.

SIDE P.L.

OWNER W. E. Wilson

0 TRACT DWELL. 1 UNIT 5 INDUSTRIAL

MAIL ADDRESS 322 W. Regent St.

1 DWELL. 1 UNIT 6 PUBLIC BLDG.

CITY Inglewood TEL. NO. DR-7-8931

2 DUPLEX 2 UNITS 7 ADDN., ALT., ETC.

ARCHITECT OR ENGINEER TEL. NO.

3 APT. UNITS 8 MISCEL.

ADDRESS

4 COMMERCIAL

CONTRACTOR W. E. Wilson TEL. NO. DR-7-8931

INSPECTION RECORD

ADDRESS 322 W. Regent St.

Computed to PG 1502

DESCRIPTION OF WORK

NEW ADD ALTER REPAIR DEMOLISH

SO. FT. SIZE 1066 NO. OF STORIES 1 NO. OF FAMILIES 1

USE OF STRUCTURE Residence +

Garage

SIGNATURE OF APPLICANT W. E. Wilson

APPROVALS

ADDRESS Same

\$ 10,000

DATE INSPECTOR'S SIGNATURE

VALUATION

P.C. FEE \$ 12.00

FEE \$ 24.00

I HEREBY ACKNOWLEDGE THAT I HAVE READ THIS APPLICATION AND STATE THAT THE ABOVE IS CORRECT AND AGREE TO COMPLY WITH ALL COUNTY ORDINANCES AND STATE LAWS REGULATING BUILDING CONSTRUCTION.

SIGNATURE OF PERMITTEE W. E. Wilson

FOUNDATION: LOCATION FORMS, MATERIALS 11/1/56 Callahan

FRAME: FIRE STOPS, BRACING, BOLTS 11/1/53 Callahan

FURNACE: LOCATION, GAS VENT, DUCTS 11/1/53 Callahan

LATH. INT. 11/1/53 Callahan

LATH. EXT. 11/1/53 Callahan

HOUSE NUMBER CORRECT AND POSTED 12/21/56 Chinn

FINAL

JOHN A. LAMBIE, COUNTY ENGINEER

VALIDATION
 CASH MO

CLYDE N. DIRLAM, CHIEF BLDG. INSPECTOR

LAC 46348 OCT 22 1956

12.00 - LAC 46358 OCT 22 1956

24.00

W. E. Wilson

W. E. Wilson

APPLICATION FOR PLUMBING PERMIT

1

DIVISION OF BUILDING AND SAFETY

Department of County Engineer
County of Los Angeles

JOHN A. LAMBIE, COUNTY ENGINEER
CASSATT D. GRIFFIN, SUPT OF BUILDING

FOR APPLICANT TO FILL IN

OWNER *W. Wilson*
MAIL ADDRESS

CITY TEL. NO.

PLUMBER **BUREAU PLUMBING CO.**

ADDRESS *4520 Manhattan Beach Blvd.*

CITY *Lawndale, California* TEL. NO. *FRONTIER 4-7817*

LICENSE NO. *115179 C36*

NUMBER	TYPE OF FIXTURE OR ITEM		FEE
/	WATER CLOSET (TOILET)	@ \$1.00	\$ 1.00
/	BATH TUB	@ \$1.00	1.00
	SHOWER	@ \$1.00	
/	LAVATORY (WASH BASIN)	@ \$1.00	1.00
/	KITCHEN SINK	@ \$1.00	1.00
	DISHWASHER	@ \$1.00	
	LAUNDRY TUB OR TRAY	@ \$1.00	
/	CLOTHES WASHER	@ \$1.00	1.00
/	WATER HEATER	@ \$1.00	1.00
/	GAS SYSTEM	@ \$1.00	1.00

PERMIT \$ 1.00
TOTAL FEE *8.00*

I HEREBY ACKNOWLEDGE THAT I HAVE READ THIS APPLICATION AND STATE THAT THE ABOVE IS CORRECT AND AGREE TO COMPLY WITH ALL COUNTY ORDINANCES AND STATE LAWS REGULATING PLUMBING.

I HEREBY CERTIFY THAT I AM PROPERLY REGISTERED AND/OR LICENSED AS REQUIRED BY LOS ANGELES COUNTY AND STATE OF CALIFORNIA OR THAT I AM THE LEGAL OWNER OF THE ABOVE DESCRIBED RESIDENTIAL PROPERTY.

SIGNATURE OF PERMITTEE *[Signature]*

BUILDING ADDRESS *4719 W 152nd St*
LOCALITY *Lawndale*
NEAREST CROSS ST. *Clayton*

DISTRICT NO. *7* GROUP *I* ZONE *M-1* READY FOR INSPECTION

INDUSTRIAL WASTE APPROVAL

INSPECTION RECORD

APPROVALS

	DATE	INSPECTOR'S SIGNATURE
UNDER SLAB WORK		
ROUGH PLUMBING	<i>11/13</i>	<i>[Signature]</i>
GAS PIPING	<i>11/13</i>	<i>[Signature]</i>
GAS VENT		
HOT WATER HEATER		
PLUMBING FIXTURES		
GAS TEST		
UTILITY CO. NOTIFIED	<i>7/17/71</i>	<i>[Signature]</i>
FINAL		

JOHN A. LAMBIE, COUNTY ENGINEER

VALIDATION

ROBERT A. WOOD, CHIEF PLBG. INSPECTOR

CR. 5555 NOV 7 3 8.00

m. Lavo

To Demolish Existing Driveway of approximately 200 square feet
 (9.5 x 21) DIS AND LEVEL OUT APPROXIMATELY 4 INCHES INSTALL RE-
 INFORMENT (W/ REINFORC) POUR NEW CONCRETE

4719 W. 151st St.

150

386

772 ± 38.6'

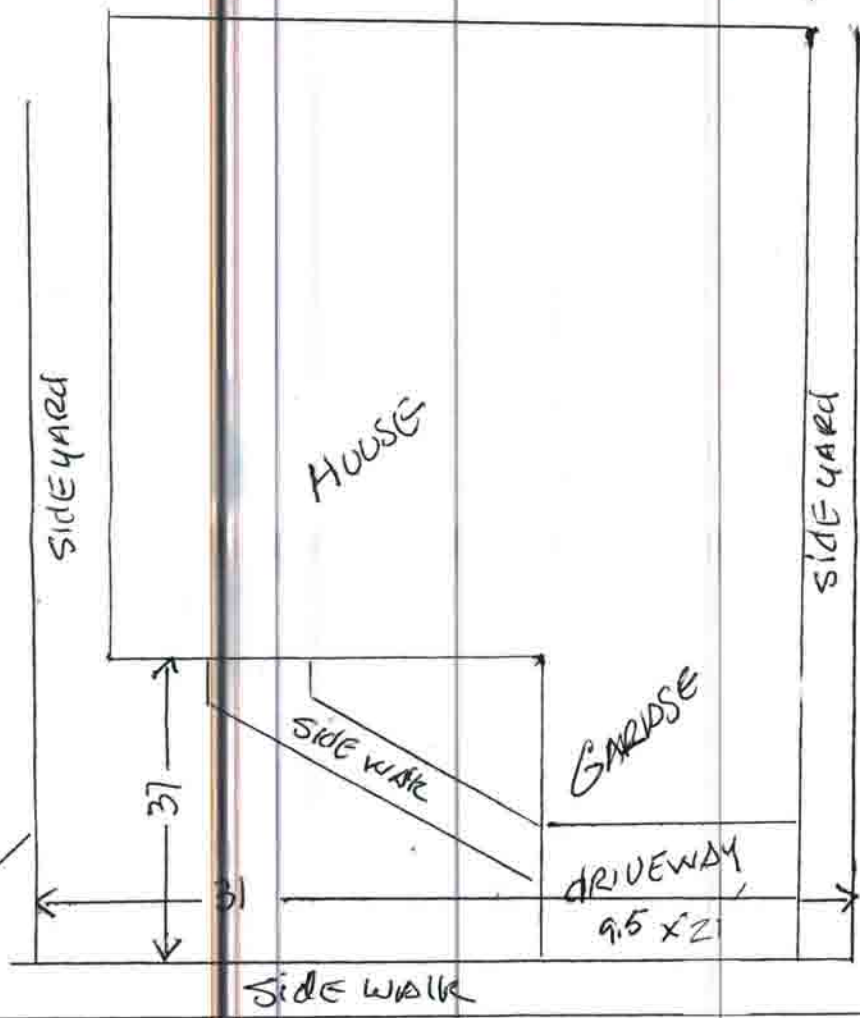

CITY OF LAWDALE
 Community Development
 Department
 APPROVED: *[Signature]*
 CONDITIONALLY
 APPROVED:
 DATE: 6.18.08

20