

4515 West 149th Street

Lawndale

# APPLICATION FOR PERMIT

## SEWER—SEWAGE DISPOSAL

### DIVISION OF BUILDING AND SAFETY

Department of County Engineer  
County of Los Angeles

JOHN A. LAMBIE, COUNTY ENGINEER  
CASSATT D. GRIFFIN, SUP'T OF BUILDING

#### FOR APPLICANT TO FILL IN

LEGAL DESCRIPTION LOT NO. 243, 1 & 2  
BLOCK 8 TRACT Lawndale  
SIZE OF LOT 50 X 150 NO. OF BLDGS. 1  
USE OF BUILDINGS Res

CONTRACTOR Chet Kohler County  
ADDRESS P.O. Box 1206  
CITY Jor TEL. NO.

REGISTRATION NO. 149019-C-42  STATE  COUNTY

NO.	DESCRIPTION OF WORK	FEE
1	HOUSE SEWER CONNECTING TO PUBLIC SEWER	@ \$3.50 <b>3.50</b>
	SEPTIC TANK, SEEPAGE PIT OR PITS AND/OR DRAINFIELD	@ \$3.00
	OVERFLOW SEEPAGE PIT, DRAINFIELD EXTN., CESSPOOL, DRYWELL, MANHOLE	@ \$2.00
	HOUSE SEWER CONNECTING TO PRIVATE DISPOSAL SYSTEM	@ \$1.00
	CONNECT ADDITIONAL BLDG. OR WORK TO HOUSE SEWER	@ \$1.00
	ALTER, REPAIR OR ABANDON HOUSE SEWER OR DISPOSAL SYSTEM	@ \$1.00

<b>OWNER'S AUTHORIZATION</b>	PERMIT	\$ 1.00
	TOTAL FEE	<b>4.50</b>

I HAVE AT THIS DATE A CONTRACT WITH THE HEREIN NAMED CONTRACTOR TO CONNECT THE ABOVE DESCRIBED EXISTING DWELLING TO THE PUBLIC SEWER.

SIGNED THIS new DAY OF 19  
OWNER OR OWNERS AGENT  
ADDRESS

I HEREBY ACKNOWLEDGE THAT I HAVE READ THIS APPLICATION AND STATE THAT THE ABOVE IS CORRECT AND AGREE TO COMPLY WITH ALL COUNTY ORDINANCES AND STATE LAWS REGULATING PLUMBING AND SEWERS.

I HEREBY CERTIFY THAT I AM PROPERLY REGISTERED AND/OR LICENSED AS REQUIRED BY LOS ANGELES COUNTY AND STATE OF CALIFORNIA OR THAT I AM THE LEGAL OWNER OF THE ABOVE DESCRIBED RESIDENTIAL PROPERTY.

SIGNATURE OF PERMITTEE Chet Kohler

BUILDING ADDRESS 4515 W 149th St  
LOCALITY Lawndale  
NEAREST CROSS ST. Marsel.  
OWNER Quall  
MAIL ADDRESS 4523 W 149th St  
CITY TEL. NO.

DISTRICT NO. 7 GROUP I MAP 165 BK 6-173

CONNECTION DATA  
STATION 8+24.2 DEPTH 7'  
MANHOLE REFERENCE 175.8 S.  UPPER  LOWER  
TYPE OF CONNECTION Kelly CURB PA LENGTH FROM M.L. TO P.L. 5' Alley

CO. EMP. NO. 1178 P. C. NO. JOB NO.  
TRUNK PERMIT NO. ROAD PERMIT NO.  
STATE ENCROACHMENT PERMIT NO.  
INDUSTRIAL WASTE APPROVAL

CONNECTION CHARGE FEE  
REIMBURSEMENT FEE

APPROVALS	DATE	INSPECTOR'S SIGNATURE
NEW HOUSE SEWER	<u>7/3/77</u>	<u>Chandra</u>
CONNECT ADDITIONAL BUILDINGS OR WORK		
SEPTIC TANK, SEEP. PIT(S) AND/OR DRAINFIELD		
CESSPOOL <input type="checkbox"/> DRYWELL <input type="checkbox"/>		
ALTER, REPAIR, SEWER OR SEWAGE DISPOSAL SYSTEM		
DISCONNECT PLUG AND ABANDON HOUSE SEWER		
BACKFILL SEPTIC TANKS <input type="checkbox"/>		
SEEP. PIT(S) <input type="checkbox"/> CESSPOOLS <input type="checkbox"/>		

JOHN A. LAMBIE, COUNTY ENGINEER

VALIDATION  
CK. E. O. CASH

ROBERT A. WOOD, CHIEF PLBG. INSPECTOR

LAC 07936 AUG 16 4 4.50

G. Kelly

## REQUIRED INFORMATION

1. INDICATE ALL BUILDINGS ON PROPERTY.
2. INDICATE AND DIMENSION SEWAGE DISPOSAL SYSTEM WITH THE DISTANCES TO BUILDINGS AND PROPERTY LINES.
3. INDICATE SIZE OF SEPTIC TANK - DEPTH OF SEEPAGE PITS - SIZE OF CFS POOL(S).
4. INDICATE NORTH DIRECTION ON PLOT.
5. INDICATE BOTH STREETS IF CORNER.

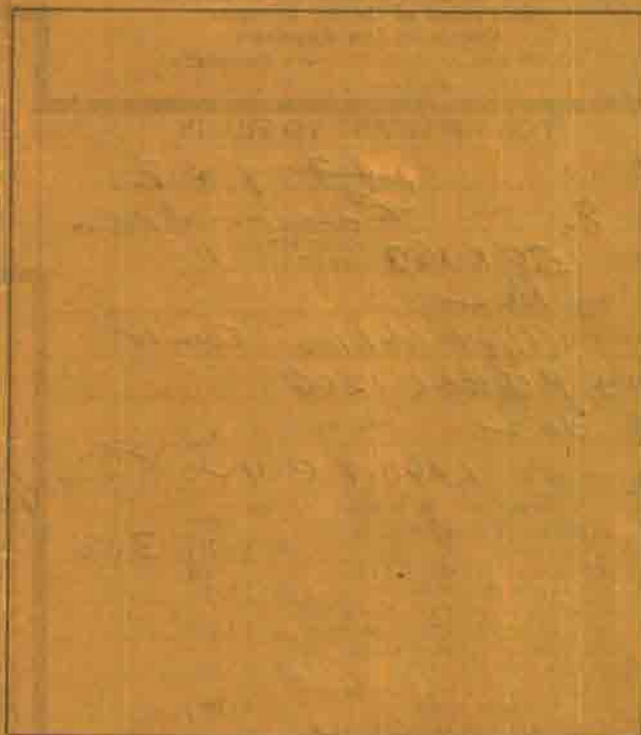

ST. ALLEY R/W

## FIELD NOTES

8/29/57 Too much dirt over sewer pipe to make inspection.

Chandra





**CITY OF LAWDALE**  
**COUNTY OF LOS ANGELES**  
**DEPARTMENT OF**  
**PUBLIC WORKS BUILDING AND SAFETY**  
**DIVISION**



14717 BURIN AVENUE  
 LAWDALE, CA 90260  
 PH: (310) 973-3236

**Building (Basic) Permit**  
**PERMIT NUMBER:**  
**PR20140000427**

<b>LEGAL ID:</b>	<b>DESCRIPTION</b>	<b>BUILDING ADDRESS:</b>		
<b>ASSESSOR INFORMATION NUMBER:</b> 4078022001	<b>WORK ITEMS:</b> Qty: UoM: Amt. Tot. Basic Building (fee based on cost valuation) 1.00 Val 596.00 596.00	4515 W 149TH ST LAWDALE CA 90260		
<b>OWNER:</b> WONG,HUI Q TR WONG FAMILY TRUST 04631 W EL SEGUNDO BLVD LAWDALE, CA 90260-0000	<b>FEES:</b> Amt. Issuance Fee 33.60 Processing Fee 20.75 Basic Building (fee based on cost valuation) 52.70 Green Building Standards Fee (GBSF) 1.00	<b>PROCESSED BY:</b> cwilson <b>PC.SUBMITAL ISSUED ON:</b> 21 May 2014 <b>EXPIRES ON:</b> 17 Nov 2014		
<b>APPLICANT:</b>	<b>CONTRACTOR:</b> MATTSON,ROGER G ET AL 4633 W EL SEGUNDO BLVD HAWTHORNE, CA 90250	<b>FINAL DATE:</b> 6/30/14 <b>FINAL BY:</b> [Signature]		
<b>ARCHITECT OR ENGINEER:</b>	<b>LICENCE NO:</b> B-1-524911	<b>USE ZONE:</b> R-1	<b>GROUP:</b> R-3	<b>CONST. TYPE:</b> V-B
<b>LEAD HAZARD WARNING:</b> Due to the possible presence of lead-based paint, lead-safe work practices are required for all repairs that disturb paint in pre-1979 buildings. Failure to do so could create lead hazards that violate California Health and Safety Code, Sections 17920.10 and 105256 with potential fines for violations up to \$5,000 (Section [d] amended) or imprisonment for not more than 6 months in the county jail or both. For more information call 1-800-LA-4-LEAD.	<b>TOTAL FEES PAID:</b> 186.45	<b>DIST:</b> 7.01	<b>FIRE ZONE:</b> 3	
		<b>STATISTICAL CLASSIFICATION:</b> <b>DESCRIPTION OF WORK:</b> REROOF EXISTING DETACHED GARAGE APROX (400 SQFT) WITH COMPOSITION SHINGLE AT THE PROPERTY ADDRESSED AS 4515 W. 149TH STREET		
		<b>SPECIAL CONDITIONS:</b>		
		<b>APPROVAL</b>	<b>DATE</b>	<b>INSPECTOR</b>
		Location (Setback & Yards)		
		Foundations		
		Slab		
		Frame/Sheeting		
		Energy Insulation		
		Lath/Drywall-Interior		
		Lath-Exterior		
		House Number - Correct & Posted		
		Final		
		Certificate of Occupancy Issued		
		Planning		

INSPECTOR COPY

**THIS PERMIT WILL EXPIRE IF CONSTRUCTION IS NOT STARTED WITHIN SIX (6) MONTHS OF THE DATE APPROVED BY THE BUILDING OFFICIAL. CONSTRUCTION ACTIVITY MAY BE CONDUCTED BETWEEN THE HOURS OF 7 A.M. AND 7 P.M., MONDAY THROUGH FRIDAY (EXCEPT NATIONAL HOLIDAYS), AND 8 A.M. AND 5 P.M. SATURDAYS. CONSTRUCTION ACTIVITY IS PROHIBITED AT ALL OTHER HOURS AND ON SUNDAYS AND NATIONAL HOLIDAYS.** Printed on: 21 May 2014



**CITY OF LAWDALE**  
**COUNTY OF LOS ANGELES**  
**DEPARTMENT OF**  
**PUBLIC WORKS BUILDING AND SAFETY**  
**DIVISION**



14717 BURIN AVENUE  
 LAWDALE, CA 90260  
 PH: (310) 973-3236

**Building (Basic) Permit**  
**PERMIT NUMBER:**  
**PR20140000424**

<b>LEGAL ID:</b>	<b>DESCRIPTION</b>	<b>BUILDING ADDRESS:</b>		
<b>ASSESSOR INFORMATION NUMBER:</b> 4078022001	<b>WORK ITEMS:</b> Basic Building (fee based on cost valuation)	4515 W 149TH ST LAWDALE CA 90260		
<b>OWNER:</b> WONG,HUI Q TR WONG FAMILY TRUST 44051 W 149TH ST LAWDALE, CA 90260-0000	<b>Qty: UoM: Amt. Tot.</b> 1.00 Val 2,204.00 2,204.00	<b>PROCESSED BY:</b> cwilson		
<b>APPLICANT:</b>	<b>FEES:</b>	<b>PC.SUBMITAL ISSUED ON:</b> 21 May 2014		
<b>CONTRACTOR:</b> MATTSON,ROGER G ET AL 4633 W EL SEGUNDO BLVD HAWTHORNE , CA 90250	Issuance Fee 33.60 Basic Building (fee based on cost valuation) 116.30 Building Group R/Other Fee 0.50 Green Building Standards Fee (GBSF) 1.00 Processing Fee 99.15	<b>EXPIRES ON:</b> 17 Nov 2014		
<b>ARCHITECT OR ENGINEER:</b>	<b>TOTAL FEES PAID: 253.95</b>	<b>FINAL DATE:</b> 5/30/14		
<b>LEAD HAZARD WARNING:</b> Due to the possible presence of lead-based paint, lead-safe work practices are required for all repairs that disturb paint in pre-1979 buildings. Failure to do so could create lead hazards that violate California Health and Safety Code, Sections 17920.10 and 105256 with potential fines for violations up to \$5,000 (Section [d] amended) or imprisonment for not more than 6 months in the county jail or both. For more information call 1-800-LA-4-LEAD.		<b>FINAL BY:</b> [Signature]		
		<b>USE ZONE:</b> R-1	<b>GROUP:</b> R-3	<b>FIRE ZONE:</b> 3
		<b>CONST. TYPE:</b> V-B	<b>DIST:</b> 7.01	
		<b>STATISTICAL CLASSIFICATION: 85</b>		
		<b>DESCRIPTION OF WORK:</b> REROOF EXISTING SFR APROX (700 SQFT) WITH COMPOSITION SHINGLE AT THE PROPERTY ADDRESSED AS 4515 W. 149TH STREET		
		<b>SPECIAL CONDITIONS:</b>		
		<b>APPROVAL</b>	<b>DATE</b>	<b>INSPECTOR</b>
		Location (Setback & Yards)		
		Foundations		
		Slab		
		Frame/Sheeting		
		Energy Insulation		
		Lath/Drywall-Interior		
		Lath-Exterior		
		House Number - Correct & Posted		
		Final		
		Certificate of Occupancy Issued		
		Planning		

INSPECTOR COPY

**THIS PERMIT WILL EXPIRE IF CONSTRUCTION IS NOT STARTED WITHIN SIX (6) MONTHS OF THE DATE APPROVED BY THE BUILDING OFFICIAL. CONSTRUCTION ACTIVITY MAY BE CONDUCTED BETWEEN THE HOURS OF 7 A.M. AND 7 P.M., MONDAY THROUGH FRIDAY (EXCEPT NATIONAL HOLIDAYS), AND 8 A.M. AND 5 P.M. SATURDAYS. CONSTRUCTION ACTIVITY IS PROHIBITED AT ALL OTHER HOURS AND ON SUNDAYS AND NATIONAL HOLIDAYS.** Printed on: 21 May 2014



# APPLICATION FOR PLUMBING PERMIT

1

## DIVISION OF BUILDING AND SAFETY

Department of County Engineer  
County of Los Angeles

JOHN A. LAMBIE, COUNTY ENGINEER  
CASSATT D. GRIFFIN, SUPT. OF BUILDING

BUILDING ADDRESS *4515 W. 149th St.*

LOCALITY *Lawndale*  
NEAREST CROSS ST. *Morse*

### FOR APPLICANT TO FILL IN

OWNER *Russell*

MAIL ADDRESS

CITY TEL. NO.

PLUMBER *Jack B. Stanford Plumb. Co., Inc.*

ADDRESS *8740 Palm Ave.*

CITY *Bellflower* TEL. NO. *Me-05845*

LICENSE NO. *154088*

NUMBER	TYPE OF FIXTURE OR ITEM	@	FEE	FEE
<i>1</i>	WATER CLOSET (TOILET)	<i>@</i>	<i>\$1.00</i>	<i>\$ 1.00</i>
<i>1</i>	BATH TUB	<i>@</i>	<i>\$1.00</i>	<i>1.00</i>
	SHOWER	<i>@</i>	<i>\$1.00</i>	
<i>1</i>	LAVATORY (WASH BASIN)	<i>@</i>	<i>\$1.00</i>	<i>1.00</i>
<i>1</i>	KITCHEN SINK	<i>@</i>	<i>\$1.00</i>	<i>1.00</i>
	DISHWASHER	<i>@</i>	<i>\$1.00</i>	
	LAUNDRY TUB OR TRAY	<i>@</i>	<i>\$1.00</i>	
<i>1</i>	CLOTHES WASHER	<i>@</i>	<i>\$1.00</i>	<i>1.00</i>
<i>1</i>	WATER HEATER	<i>@</i>	<i>\$1.00</i>	<i>1.00</i>
<i>1</i>	GAS SYSTEM	<i>@</i>	<i>\$1.00</i>	<i>1.00</i>

PERMIT \$ *1.00*  
TOTAL FEE *8.00*

I HEREBY ACKNOWLEDGE THAT I HAVE READ THIS APPLICATION AND STATE THAT THE ABOVE IS CORRECT AND AGREE TO COMPLY WITH ALL COUNTY ORDINANCES AND STATE LAWS REGULATING PLUMBING.

I HEREBY CERTIFY THAT I AM PROPERLY REGISTERED AND/OR LICENSED AS REQUIRED BY LOS ANGELES COUNTY AND STATE OF CALIFORNIA OR THAT I AM THE LEGAL OWNER OF THE ABOVE DESCRIBED RESIDENTIAL PROPERTY.

SIGNATURE OF PERMITTEE *Jack B. Stanford*

DISTRICT NO. *7* GROUP *M* ZONE *1* READY FOR INSPECTION

INDUSTRIAL WASTE APPROVAL

### INSPECTION RECORD

### APPROVALS

	DATE	INSPECTOR'S SIGNATURE
UNDER SLAB WORK	<i>7/15/57</i>	<i>Chun</i>
ROUGH PLUMBING	<i>7/15/57</i>	<i>Chun</i>
GAS PIPING		
GAS VENT		
HOT WATER HEATER		
PLUMBING FIXTURES		
GAS TEST		
UTILITY CO. NOTIFIED	<i>7/15/57</i>	<i>Chun</i>
FINAL		

JOHN A. LAMBIE, COUNTY ENGINEER

### VALIDATION

ROBERT A. WOOD, CHIEF PLBG. INSPECTOR

CK. *(initials)*

M. S. CASH  
*W. 208 BR JUL 1 3 8.00*

*G. Kelly*

155-003

4515

1

SA663-CES06 - 10-56

# APPLICATION FOR ELECTRIC PERMIT

BUILDING AND SAFETY DIVISION  
Department of County Engineer  
County of Los Angeles  
JOHN A. LAMBIE, COUNTY ENGINEER  
CASSATT D. GRIFFIN, SUP'T OF BUILDING

### FOR APPLICANT TO FILL IN PERMIT FEES

LIGHTS <u>787</u>		RECEPTACLES <u>13</u>		SWITCHES <u>5</u>	
NUMBER	ITEM	EACH	FEE		
25	TOTAL OUTLETS	.10	\$ 2. 50		
	ELEC. RANGES, WATER HEATERS, CLOTHES DRYERS	.50			
1	ELEC. SPACE HEATERS, STAT'Y. COOKING UNITS, GARBAGE DISPOSERS, AUTO WASHERS, DISHWASHER	.25	25		
7	LIGHTING FIXTURES	.10	70		
MOTORS					
HORSEPOWER					
H.P.	OVER	INC.			
		1/2 & LESS	.25		
	1/2	— 2	.50		
	2	— 5	1.00		
	5	— 15	1.50		
	15	— 50	2.50		
	50	— 200	5.00		
MISC.					
SIGN NO. TRANS NO. LAMPS					
SERVICE 0 - 600V		1.00	1.00		
SERVICE OVER 600V		5.00			
WIRING PERMIT		1.00	1.00		
FIXTURE PERMIT		1.00	1.00		
SUPPLEMENTARY PERMIT		.50			
TOTAL FEE			\$ 6.25		

BUILDING ADDRESS 4523 W. 149th. St.

LOCALITY Lawndale

NEAREST CROSS ST.

OWNER Quale

MAIL ADDRESS 4523 W. 149th. St.

CITY Lawndale TEL. NO.

ELECTRICIAN SO. CAL. ELECT. SER. CO.

ADDRESS 8608 E. ARTUSTIA BLVD. ME 3-5300

CITY BELLFLOWER TEL. NO.

STATE LICENSE NO. 118787 5-30-5

DISTRICT NO.	GROUP	ZONE	READY FOR INSPECTION
<u>7</u>	<u>Model</u>		

### INSPECTION RECORD

### APPROVALS

	DATE	INSPECTOR'S SIGNATURE
CONDUIT	<u>8/4/57</u>	<u>Chimura</u>
WIRING		
FIXTURES		
POWER		
UTILITY CO. NOTIFIED	<u>10/15/57</u>	<u>Chimura</u>
FINAL		

I HEREBY ACKNOWLEDGE THAT I HAVE READ THIS APPLICATION AND STATE THAT THE ABOVE IS CORRECT AND AGREE TO COMPLY WITH ALL COUNTY ORDINANCES AND STATE LAWS REGULATING ELECTRICAL WIRING.

I HEREBY CERTIFY THAT I AM PROPERLY REGISTERED AND/OR LICENSED AS REQUIRED BY LOS ANGELES COUNTY AND STATE OF CALIFORNIA OR THAT I AM THE LEGAL OWNER OF THE ABOVE DESCRIBED RESIDENTIAL PROPERTY.

SIGNATURE OF PERMITTEE [Signature]

VALIDATION  
CASH

ARTHUR C. VEIT,  
SUPERVISING ELECTRICAL ENGINEER

RECEIVED

AUG - 7 1957

R & S DIST. 7

G. Kelly



# APPLICATION FOR BUILDING PERMIT

**BUILDING AND SAFETY DIVISION**  
 Department of County Engineer  
 County of Los Angeles  
**JOHN A. LAMBIE, COUNTY ENGINEER**  
 CASSATT D. GRIFFIN, SUP'T OF BUILDING

**BUILDING ADDRESS** 4515 N. 149th St.  
**LOCALITY** Lawndale  
**NEAREST CROSS ST.** Marshall

**FOR APPLICANT TO FILL IN**

**BUILDING ADDRESS** N. 149th St.  
**LOT NO.** 1042 **BLOCK** 8  
**TRACT** Lawndale  
**SIZE OF LOTS** 50 X 150 **NO. OF BLDGS. NOW ON LOT** 1  
**USE OF EXISTING BLDG.** dwg.  
**OWNER** Elmer H. Duality  
**MAIL ADDRESS** 4523 N. 149th St.  
**CITY** Lawndale **TEL. NO.** OS 67214  
**ARCHITECT OR ENGINEER** **TEL. NO.**  
**ADDRESS**  
**CONTRACTOR** Trident Const. Co. **TEL. NO.** OS 51176  
**ADDRESS** 1492 S. Hawthorne Hawthorne

**DISTRICT NO.** 9 **GROUP** I+J **TYPE** CONST. **SEWER** BK 6 **MAP** PG 173  
**STATISTICAL CLASSIFICATION**  
**CLASS. NO.** 1 **DWELL. UNITS** 1 **hab**  
**MAP NUMBER** 4155 **STATE HWY** YES  NO   
**USE ZONE** A-1 **SPECIAL CONDITIONS** 5000  
**BUILDING SETBACK**  

	YARD	HWY	STREET NAME	EXIST. WIDTH
FRONT P.L.	20'		<del>Marshall</del>	50'
SIDE P.L.	5'		149th	60'

**DESCRIPTION OF WORK**

NEW	ALTER	REPAIR	DEMOLISH
<input checked="" type="checkbox"/>	<input type="checkbox"/>	<input type="checkbox"/>	<input type="checkbox"/>
<b>SQ. FT. SIZE</b> 852 dwg. 400 gar.	<b>NO. OF STORIES</b> 1	<b>NO. OF FAMILIES</b> 1	
<b>USE OF STRUCTURE</b> dwg + detached garage			
<b>SIGNATURE OF APPLICANT</b> J. H. Strehlow			
<b>ADDRESS</b> 1492 S. Hawthorne, Hawthorne			
<b>\$</b> I 7800. T 1000.	<b>P.C. FEE</b> \$ 10.00		
<b>VALUATION</b> 2800.	<b>FEE</b> \$ 26.00		

I HEREBY ACKNOWLEDGE THAT I HAVE READ THIS APPLICATION AND STATE THAT THE ABOVE IS CORRECT AND AGREE TO COMPLY WITH ALL COUNTY ORDINANCES AND STATE LAWS REGULATING BUILDING CONSTRUCTION.  
**SIGNATURE OF PERMITTEE** J. H. Strehlow  
**ADDRESS** 1492 S. Hawthorne, Hawthorne

**INSPECTION RECORD**

8/1/57	J. Kelly	ok
8/1/57	J. Kelly	except bath
8/1/57	J. Kelly	chimney not covered?
<b>APPROVAL</b>		

	DATE	INSPECTOR'S SIGNATURE
<b>FOUNDATION: LOCATION FORMS, MATERIALS</b>	8/1/57	Chinn
<b>FRAME: FIRE STOPS, BRACING, BOLTS</b>	8/1/57	Chinn
<b>FURNACE: LOCATION, GAS VENT, DUCTS</b>	8/1/57	Chinn
<b>LATH INT.</b>	8/1/57	Chinn
<b>LATH EXT.</b>	8/1/57	Chinn
<b>HOUSE NUMBER CORRECT AND POSTED</b>	8/1/57	Chinn
<b>FINAL</b>		

**JOHN A. LAMBIE, COUNTY ENGINEER.**

**CLYDE N. DIRLAM, PRINCIPAL STRUCTURAL ENGINEER**

**PLAN CHECK VALIDATION** CR M.O. CASH

10036015 JUL 31 6 10.00

Sm Lant

**PERMIT VALIDATION** CR M.O. CASH

89085 JUL 1 26.00

G. Kelly



# CITY OF LAWDALE

## APPLICATION FOR BUILDING PERMIT

1

COUNTY OF LOS ANGELES  
DEPARTMENT OF COUNTY ENGINEER  
BUILDING AND SAFETY DIVISION  
JOHN A. LAMBIE, COUNTY ENGINEER  
WILLIAM A. JENSEN, SUP'T OF BUILDING

### FOR APPLICANT TO FILL IN

BUILDING ADDRESS <b>4515-149</b>	
LOT NO. <b>Westly 60.00 feet</b> BLOCK <b>Regal</b>	
TRAFFIC <b>measured at right angles to lane 2</b>	
SIZE OF LOT <b>Block 8.</b>	NO. OF BLDGS. NOW ON LOT
USE OF EXISTING BLDG. <b>Garage.</b>	
OWNER <b>Charles B. Holt.</b>	TEL. NO. <b>05-91777</b>
ADDRESS <b>14419 Prairie</b>	
ARCHITECT OR ENGINEER	TEL. NO.
ADDRESS	
CONTRACTOR <b>owner</b>	TEL. NO.
ADDRESS	

### DESCRIPTION OF WORK

NEW	ADD	ALTER	REPAIR	DEMOLISH
SQ. FT. SIZE <b>400</b>			NO. OF STORIES <b>1</b>	NO. OF FAMILIES
USE OF STRUCTURE <b>Garage 3' East</b>				
SIGNATURE OF APPLICANT <b>Mrs Charles B Holt.</b>				
VALUATION \$ <b>1200</b>				

P.C. FEE \$	PMT. FEE \$ <b>11.50</b>
I HEREBY ACKNOWLEDGE THAT I HAVE READ THIS APPLICATION AND STATE THAT THE ABOVE IS CORRECT AND AGREE TO COMPLY WITH ALL COUNTY ORDINANCES AND STATE LAWS REGULATING BUILDING CONSTRUCTION. I CERTIFY THAT IN DOING THE WORK AUTHORIZED HEREBY I WILL NOT EMPLOY ANY PERSON IN VIOLATION OF THE LABOR CODE OF THE STATE OF CALIFORNIA RELATING TO WORKMEN'S COMPENSATION INSURANCE.	
SIGNATURE OF PERMITTEE <b>Charles B Holt</b>	
ADDRESS <b>14419 Prairie Lawndale</b>	

BUILDING ADDRESS <b>4515-149</b>			
LOCALITY			
NEAREST CROSS ST. <b>Hawthorne</b>			
DISTRICT NO. <b>7.01</b>	GROUP <b>J</b>	TYPE CONST.	PROCESSED BY
STATISTICAL CLASSIFICATION CLASS. NO. <b>23</b>		DWELL UNITS	SEWER MAP BK <b>193</b> PG
WATER CERTIFICATE: NOT REQUIRED <input checked="" type="checkbox"/>		RECEIVED <input type="checkbox"/>	
MAP NO. <b>4155</b>	HIGHWAY (CIRCLE)	STATE MAJOR SECOND. <b>LOCAL</b>	
USE ZONE <b>R1</b>	SPECIAL CONDITIONS		
BUILDING SETBACK	YARD	HWY	STREET NAME
FRONT P.L. <b>20</b>			<b>Mansel</b>
SIDE P.L. <b>5</b>			<b>149 St</b>
			EXIST. WIDTH <b>50'</b>
			<b>60'</b>
APPROVALS		DATE	INSPECTOR'S SIGNATURE
FOUNDATION: LOCATION FORMS, MATERIALS			
FRAME: FIRE STOPS, BRACING, BOLTS			
FURNACE: LOCATION, GAS VENT, DUCTS			
LATH. INT.			
LATH. EXT.			
HOUSE NUMBER CORRECT AND POSTED			
FINAL			

INSPECTOR COPY

PLAN CHECK VALIDATION

CK. M.O. CASH

JOHN F. LEWIS, PRINCIPAL STRUCTURAL ENGINEER  
PERMIT VALIDATION

CK. M.O. **CASH**

LAC 13728 SEP 1 1

11.50 +

*an*

*City of Hawthorne  
July 19*

## APPLICATION FOR PLUMBING PERMIT

**COUNTY OF LOS ANGELES  
DEPARTMENT OF COUNTY ENGINEER  
BUILDING AND SAFETY DIVISION  
JOHN A. LAMBIE, COUNTY ENGINEER  
WILLIAM A. JENSEN, SUPT OF BUILDING**

<b>BUILDING ADDRESS</b> 4515 W 149 St	
<b>LOCALITY</b>	
<b>NEAREST CROSS ST.</b>	
<b>OWNER</b> Schutte	
<b>MAIL ADDRESS</b> Lawndale	
<b>CITY</b>	<b>TEL. NO.</b>
<b>CONTRACTOR</b> HURD PLUMBING	
<b>ADDRESS</b> 2041 Edison Ave. Los Angeles 15, Calif.	
<b>CITY</b> DR. 2-28	<b>TEL. NO.</b> 7-3264
<b>CONTRACTOR'S REGISTRATION NO.</b> 121499	<b>COUNTY</b> C-36 <input type="checkbox"/>

**FOR APPLICANT TO FILL IN**

NUMBER	FIXTURE OR ITEM
	WATER CLOSET
	BATH TUB
	SHOWER
	LAVATORY
	SINK
	DISHWASHER
	LAUNDRY TUB
	CLOTHES WASHER
	WATER HEATER
	GAS SYSTEM

/	* \$1.00 PER ITEM OR FIXTURE	\$	100		
	PERMIT	\$	2	00	
	TOTAL FEE		3	00	

I HEREBY ACKNOWLEDGE THAT I HAVE READ THIS APPLICATION AND STATE THAT THE ABOVE IS CORRECT AND AGREE TO COMPLY WITH ALL COUNTY ORDINANCES AND STATE LAWS REGULATING PLUMBING.

I HEREBY CERTIFY THAT I AM PROPERLY REGISTERED AND/OR LICENSED AS REQUIRED BY LOS ANGELES COUNTY AND STATE OF CALIFORNIA OR THAT I AM THE LEGAL OWNER OF THE ABOVE DESCRIBED RESIDENTIAL PROPERTY.

SIGNATURE OF PERMITTEE: *[Signature]*

DISTRICT NO.	GROUP	ZONE	PROCESSED BY
7.04	Mech		
<b>INDUSTRIAL WASTE APPROVAL</b>			
<b>INSPECTION RECORD</b>			
<b>APPROVALS</b>		<b>DATE</b>	<b>INSPECTOR'S SIGNATURE</b>
UNDER SLAB WORK			
ROUGH PLUMBING			
GAS PIPING			
GAS VENT			
HOT WATER HEATER		3/2/61	<i>[Signature]</i>
PLUMBING FIXTURES			
GAS TEST			
UTILITY CO. NOTIFIED			
<b>FINAL</b>			

INSPECTOR COPY

**RECEIVED**

FEB 10 1961

B & S DIST. 7

**VALIDATION**

ROBERT A. WOOD,  
SUPERVISING MECHANICAL ENG'R

EX. N. O. CASE

10,693 60 781 58 3.00

*[Signature]*



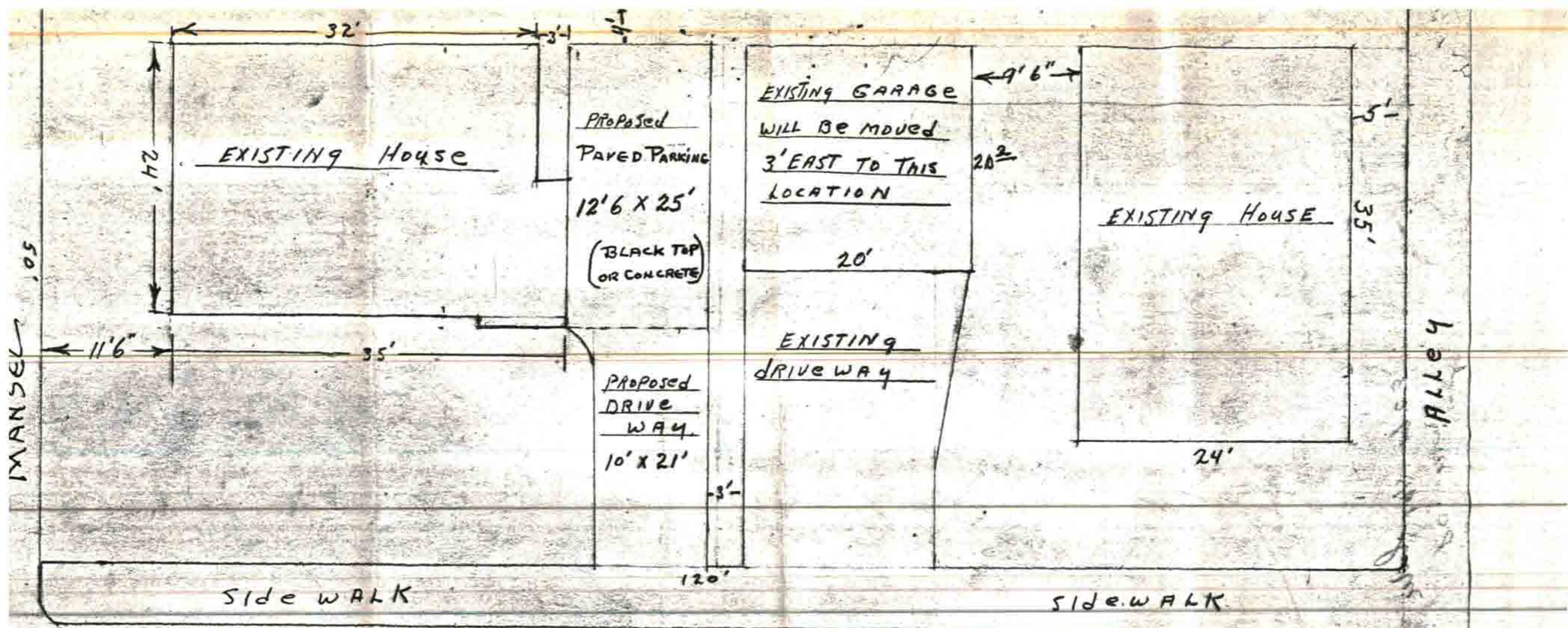

CHARLES B. HOLT

149<sup>TH</sup> ST. 14419 SO. PRAIRIE AVE

approved by  
 Planning Comm. June 28-1965

OS 91777  
 SCALE 10' = 1"



DESCRIPTION WRITTEN UNDER ORDER #6346467

PARCEL 1:

The Westerly 60.00 feet, measured at right angles, of Lots 1 and 2 of Block 8 of Lawndale, in the County of Los Angeles, State of California, as per map recorded in Book 9 Page 122 of Maps, in the office of the County Recorder of said County.

PARCEL 2:

Lots 1 and 2 of Block 8 of Lawndale, in the County of Los Angeles, State of California, as per map recorded in Book 9 Page 122 of Maps, in the office of the County Recorder of said County.

Excepting from said lots the Westerly 60.00 feet, measured at right angles.