

4444U W. 149th Street
Public Right-of-Way/Utility Box AT&T

WORKERS' COMPENSATION DECLARATION

I hereby affirm that I have a certificate of consent to sell insure, or a certificate of Workers' Compensation Insurance, or a certified copy thereof (Sec. 3800 Lab. C.)

Policy No. _____ Company _____
 Certified copy is hereby furnished.
 Certified copy is filed with the county building inspection department.
 Date _____ Applicant _____

CERTIFICATE OF EXEMPTION FROM WORKERS' COMPENSATION INSURANCE

(This section need not be completed if the work involved by the permit is for one hundred dollars (\$100) or less.)

I certify that in the performance of the work for which this permit is issued, I shall not employ any person in any manner so as to become subject to the Workers' Compensation Laws.

Date _____ Applicant _____
 NOTICE TO APPLICANT: If, after making this Certificate of Exemption, you should become subject to the Workers' Compensation provisions of the Labor Code, you must forthwith comply with such provisions or this permit shall be deemed revoked.

LICENSED CONTRACTORS DECLARATION

I hereby affirm that I am licensed under provisions of Chapter 9 (commencing with Section 7000) of Division 3 of the Business and Professions Code, and my license is in full force and effect.

License Number _____ Lic. Class _____
 Contractor _____ Date _____

I am exempt under Sec. _____
 B.&P.C. for this reason Self-employed
 Date: 1-25-10
 Signature William Kelly II

Exemption for Reg. Maint. Elect.

SINGLE FAMILY HOME OWNER-BUILDER DECLARATION

I hereby affirm that I am exempt from the Contractor's License Law for the following reason: (Section 7031.5, Business and Professions Code)

I, as owner of the property, will do the work and the structure is not intended or offered for sale (Section 7044, Business and Professions Code).

CONSTRUCTION LENDING AGENCY

I hereby affirm that there is a construction lending agency for the performance of the work for which this permit is issued (Sec. 3097, Civ. C.).

Lender's Name _____

Lender's Address _____

I certify that I have read this application and state that the above information is correct. I agree to comply with all County ordinances and State laws regulating Electrical wiring, and hereby authorize representatives of this County to enter upon the above-mentioned property for inspection purposes.

Signature of Permittee _____ Date _____

20-0019 DPW 4/87
 76A663
 (CE-808G)

APPLICATION FOR ELECTRICAL PERMIT
 COUNTY OF LOS ANGELES

BUILDING AND SAFETY

4444 W. 149TH ST

FOR APPLICANT TO FILL IN			
	EACH	NO.	FEE
New Residential Bldgs. & Pools			
1 & 2-Family, Sq. Ft. _____	\$	—	\$
Multi-family Sq. Ft. _____			
Residential Swimming Pools			
Outlets: Rec _____ Light _____ Sw _____			
Total No. _____ Additional _____			
Lighting Fixtures			
Total No. _____ First 20 _____ Additional _____			
Fixed Appliances Not Over 1 HP			
Range _____ Heater _____ D.W. _____			
Oven _____ Dryer _____ W.M. _____			
Top _____ FAU _____ W.H. _____			
Hood _____ Fan _____ Other _____			
Disp. _____ Room Air Cond. _____			
Power Apparatus & Large Appliances			
Size & Type HP, KW, KVA, or KVAR			
_____ Up to 1 Incl.			
_____ Over 1 to 10 Incl.			
_____ Over 10 to 50 Incl.			
_____ Over 50 to 100 Inc.			
_____ Over 100			
Services, Swbd., MCC & Panelboards			
0 - 200 Amp. Under 600 V	47.00	1	47.00
201 - 1000 Amp. Under 600 V			
Over 1000 Amp. or Over 600 V			
Temp. Power Pole & Appurtenances			
Sign with One Branch Circuit			
Additional Sign Branch Circuits			
Misc. Conduits & Conductors			
Other (See Complete Fee Schedule)			
PERMIT FEE (Sub-Total)			47.00
PLAN CHECKING FEE			33.60
PERMIT ISSUING FEE			50.00
TOTAL FEE			

JOB ADDRESS 4443 W. 149TH ST
 LOCALITY LAUNDRY
 NEAREST CROSS ST. BELMONT AVE
 OWNER OR FIRM NAME ATTN
 MAIL ADDRESS 100 ALONDA BL Rm 102
 CITY STANFORD 90248 Tel. No. 310 515 2461
 PLAN CHECK APPLICANT _____
 ADDRESS _____
 CITY _____ Tel. No. _____
 PERMIT APPLICANT BILL KELLY
 ADDRESS 4700 AURORA DR. #144
 CITY VENTURA CA 93003 Tel. No. 805 795 5899
 LICENSE OR REG. NUMBER 429590 Class C-10
 DISTRICT NO. 7.01 PROCESSED BY [Signature]

FINAL DATE 1-26-10
 FINAL BY [Signature]
 # VALIDATION
 01* *8060
 *8060
 10-526 Id 1 ***E
 5196
 10-38
 01-25-10

INSPECTOR COPY

SEE REVERSE FOR EXPLANATORY LANGUAGE

APPROVALS	DATE	INSPECTOR'S SIGNATURE
TEMP. POWER POLE		
UNDERSLAB WORK		
ROUGH CONDUIT	1-26-10	[Signature]
WIRING		
FIXTURES		
POWER AUTHORIZED		
UTILITY CO. NOTIFIED	1-27-10	[Signature]
FINAL	Enter on Front	

NOTES

OWNER-BUILDER DECLARATION

I hereby affirm that I am exempt from the Contractor's License Law for the following reason (Section 7031.5, Business and Professions Code): Any city or county which requires a permit to construct, alter, improve, demolish, or repair any structure, prior to its issuance, also requires the applicant for such permit to file a signed statement that he is licensed pursuant to the provisions of the Contractor's License Law (Chapter 9 (commencing with Section 7000) of Division 3 of the Business and Professions Code) or that he is exempt therefrom and the basis for the alleged exemption. Any violation of Section 7031.5 by any applicant for a permit subjects the applicant to a civil penalty of not more than five hundred dollars (\$500):

I, as owner of the property will do the work, and the structure is not intended or offered for sale.

(Sec. 7044, Business and Professions Code: The Contractor's License Law does not apply to an owner of property who builds or improves thereon, and who does such work himself provided that such improvements are not intended or offered for sale. If, however, the building or improvement is sold within one year of completion, the owner-builder will have the burden of proving that he did not build or improve for the purpose of sale.)

I am exempt under Sec. _____

B. & P.C. for this reason _____

Date: _____

Owner: _____

PLACEMENT DATA

- 1) PL. MOUNTING BRACKET KIT FOR 14" X 12" CONCRETE PAD FOR ALP-248C-LA FIBER CABINET SEE FOUNDATION TRADE NOTE R/C 8257C
- 2) PL. 21" 14" C/P.C. P.T.S FROM EQUIV. EN 1 DU 21" R/C 4C
- 3) PL. 8" 10" S/D L. 00 NO PL. (FIBER ONLY) D.E. & CAP FOR FUTURE FWR. FEED R/C 8257C
- 4) PL. 8" GROUND ROD R/C 8257C
- 5) PL. 8" GROUND ROD R/C 8257C

6) PL. ALP-248C-LA FIBER CABINET E/W 100-AMP ELECTRICAL POWER METER PART 2 (P18119TH430T) SEE CONCRETE S/DING NOTE 41 R/C 8257C

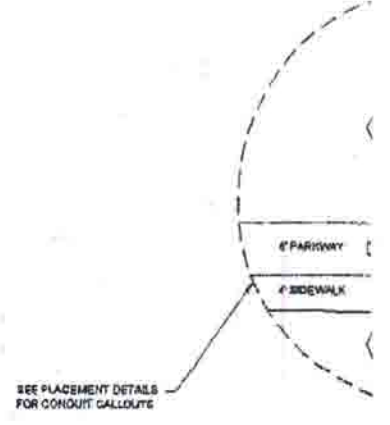
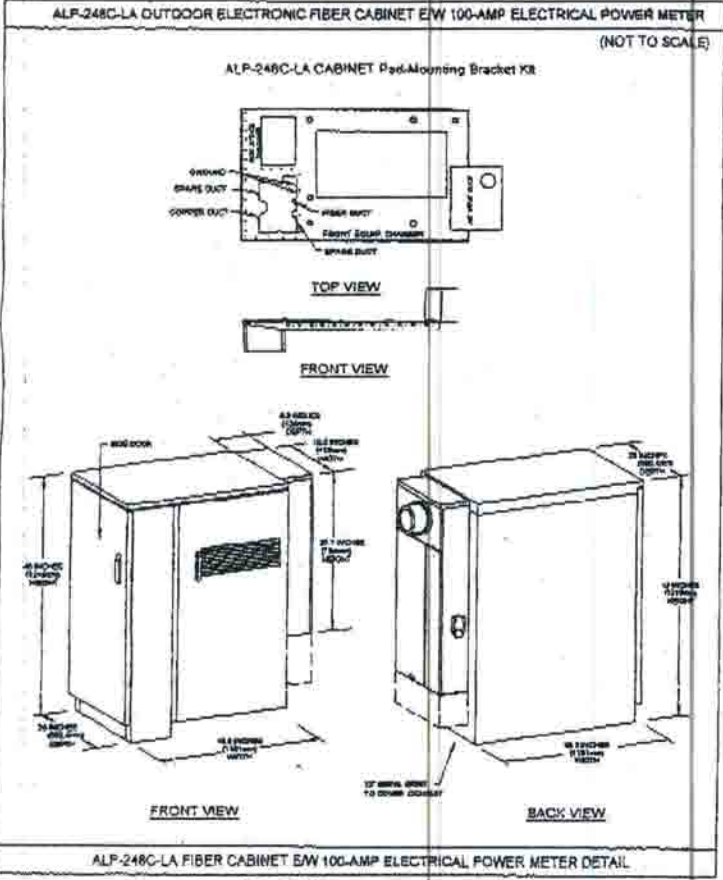
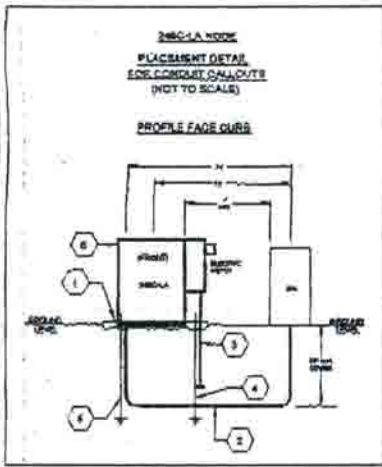

NO LAI

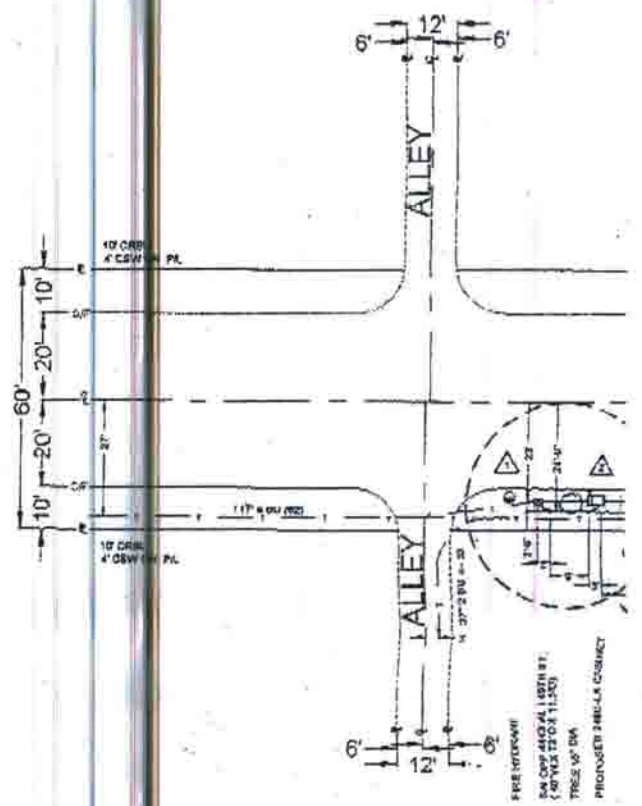

CONSTRUCTION SIGNS NOTE:

1. CONTRACTOR TO PLACE ITEMS 1 THRU 5 WHICH INCLUDES POURING A 4' x 2' CONCRETE PAD FOR ITEM 1 AND PROVIDING AN ELECTRICIAN, ELECTRICAL PERMIT AND MATERIAL TO COMPLETE ELECTRICAL WIRING AND SIGNING OFF ON THE ELECTRICAL PERMIT FOR ITEM 3. ALL BONDING AND GROUNDING MUST BE COMPLIANT WITH CenterSteps INSTRUCTION SHEET, ALP-248C-LA CABINET GROUNDING INSTRUCTIONS MANUAL, ID 380 382 694 ISSUE 2, JUNE 2007
2. MAINTAIN MINIMUM COVER OF 36" BELOW FLOWLINE OVER ALL TELCO CONDUIT PLACED.
3. THE "PAD MOUNTING BRACKET" MUST BE A MINIMUM OF 24" BEHIND CURB FACE.
4. VERIFY, BEFORE STARTING WORK, THE DIRECTION OF THE 2" DUCT SWEEP FOR POWER FIELD.
5. VERIFY EXISTING SUBSTRUCTURES PRIOR TO EXCAVATION.
6. PLACE PULL ROPE OR 1600 P POLYESTER MULE TAP IN NEW CONDUIT AND PROVIDE WAVE.
7. BACKFILL AND COMPACT ALL EXCAVATIONS, COMPLETE ALL REPAIRS AND RESTORE WORK SITE AS FOUND OR BETTER CONDITION.
8. THE CONTRACTOR MUST NOTIFY THE CITY/COUNTY INSPECTOR 24 hrs. BEFORE WORK BEGINS AND WHEN APPLICABLE, MEET WITH THE CITY/COUNTY INSPECTOR AND THE CONTRACY ADMINISTRATOR AT THE WORK SITE "PRIOR TO" OR THE "MORNING OF" START OF WORK.
9. THE CONTRACTOR IS RESPONSIBLE TO CLARIFY AND COMPLY WITH ALL PERMIT SPECIFICATIONS, INCLUDING ANY ATTACHED TRAFFIC CONTROL PLANS, OR THE CALIFORNIA "WITCH" MANUAL, IF NO OTHER INFORMATION IS SPECIFIED. THE COST OF LABOR AND MATERIAL TO MEET THESE REQUIREMENTS WILL BE INCLUDED IN THE BID.
10. ALL EXCAVATION IN STREETS AND ALLEYS WILL BE SLURRIED BACKFILLED.
11. CONTRACTOR IS RESPONSIBLE FOR INSTALLING LANDSCAPING THAT COMPLIES WITH L.A. CITY'S "LANDSCAPE CONSIDERATIONS" SHOWN ON DRAWING. ALSO, INSURE THAT THE LANDSCAPING INSTALLED IS WATERED FOR 30 DAYS OR UNTIL LANDSCAPING HAS ESTABLISHED ITSELF.
12. DWP AND/OR CONTRACTOR IS RESPONSIBLE TO PROVIDE (2) COPIES OF THE MARKED PRINT AND COVER SHEET INDICATING "ACTUAL" START DATE, COMPLETION DATE, USAGE AND JOB FOREMAN. SUBMIT MARKED PRINTS TO AT&T CALIFORNIA INSPECTOR, NAME & ADDRESS:
13. WHEN APPLICABLE THE CONTRACTOR MUST CALL THE DWP REPRESENTATIVE, NAME & NUMBER:



CONSTRUCTION REQUIREMENTS

1. MAINTAIN MINIMUM COVER OF 36" BELOW FLOWLINE.
2. VERIFY EXISTING SUBSTRUCTURES PRIOR TO EXCAVATION.
3. ALL 4" TO CONFORM TO P78-17 OR EQUIVALENT.
4. ALL 2" TO CONFORM TO P78-48 OR EQUIVALENT.
5. ALL BACKFILL TO BE SAND 12" BELOW AND 1" ABOVE.
6. DO NOT BACKFILL OVER ANY TELEPHONE BURIED SPLICE LOCATIONS UNLESS AUTHORIZED BY TELEPHONE COMPANY INSPECTOR.
7. PLACE ATTACHED GROUND WAVE AT BONDING POINTS. (SEE BONDING MANUAL.)
8. PLACE PULL ROPE IN NEW CONDUIT.
9. DO NOT CUT CURB & GUTTER OR BUS PAD.
10. ALL SURFACES AND LANDSCAPES WHICH HAVE BEEN REMOVED OR DAMAGED IN THE COURSE OF CONSTRUCTION SHALL BE RECONSTRUCTED OR REPLACED TO AT LEAST EQUAL OR BETTER THAN THE PREVIOUS OR ADJACENT SURFACE.
11. ALL TRAFFIC CONTROL TO BE IN ACCORDANCE WITH THE MANUAL ON UNIFORM TRAFFIC CONTROL DEVICES (MUTCD) LATEST EDITION.
12. PER AT&T GUIDELINES, ALL HANDHOLES, SPLICE BOXES, AND MANHOLES TO BE PURCHASED FROM EITHER NEWBASE OR UTILITY MALL.
13. MAINTAIN A MINIMUM OF 4" FROM EDGE OF EXISTING 9:1 TO EDGE OF NEW FIBER WAVE.

F.J.G. CABLE ENGINEERING, INC. # 12200 VRAD

THIS PROJECT REQUIRES EXCAVATION. CONSTRUCTION WILL UTILIZE AND IMPLEMENT ALL BEST MANAGEMENT PRACTICES (BMP's) AS REQUIRED TO ENSURE COMPLIANCE WITH AT&T POLICY LETTER ISSUE FEBRUARY 21, 2003 BY ENVIRONMENTAL MANAGEMENT CONCERNING STORM WATER PERMITTING AND STORM WATER POLLUTION PREVENTION PLANS (SWPPPs) AND IN ACCORDANCE WITH THE CLEAN WATER ACT (CWA) AND CWA REGULATIONS PUBLISHED IN 1990 AS MODIFIED BY THE PHASE II RULE IN 1997.

CONDUIT RECORD: A8070227 148TH ST. 112' W/O GREVILLEA AVE. TO BURIN AVE.

SUB MAP #

BACKFILL SHALL BE SOIL CEMENT SLURRY OR OTHER MATERIAL IN CONFORMANCE WITH CITY ENGINEER'S SPECIAL ORDER NO. 9008-0183 DATED JANUARY 28, 1982 (CITY OF L.A.)

RECOMMENDATION FOR BACKFILL SPECIAL ORDER # 09 0182

STREET TYPE	GOLF CLASS	PROPOSED BACKFILL
MAJOR	NA	NA
SECONDARY	NA	NA
LOCAL	NA	NA
ALLEY	NA	NA

LOCATION: OFF 442 W. 148TH ST.

DESCRIPTION: PLACE ONE (1) CONCRETE PAD AND ONE (1) UNDERGROUND CONDUIT FROM SAU OFF 442 W. 148TH ST. TO NEW LOCATION. PLACE 5' OF 1-1/2" DUCT (RISER ONLY).

EXCAVATION DATA

CITY OF:	LAYDALE
PLACING:	CONCRETE AND FIBER WAVE
EXCAVATION IN DIRT (CONC. PAD)	4' X 2' = 10 SQ FT
EXCAVATION IN CONCRETE SIDEWALK	
EXCAVATION IN ASPHALT STREET	
EXCAVATION IN ASPHALT ALLEY	
EXCAVATION IN DIRT	17' X 1' = 17 SQ FT
TOTAL EXCAVATION	27 SQ FT
NUMBER OF CUTS:	2

DATE	REVISIONS
02/10/07	UPDATE CALL-OUT INFO - RK

PROJECT ENGINEER: KHALIL KARIEM
 TELEPHONE: 626-570-5481
 EMAIL: kkar@at.com
 PROJECT MANAGER: PULSINATE LUMPHY
 TELEPHONE: 310-616-0473
 TITLE: AS-CF
 DRAWING NO: 7485549 311704
 DRAWING: 1/1



'A-A'
1" = 10'
G REQUIRED



CONDUIT CURVE DATA		
ANGLE	RADIUS	LENGTH
90° 00' 00"	2'	3'-0"
90° 00' 00"	2'	3'-2"

	DATE	AT&T ID
DRAWN	5-14-02	F.J.G. - MH
CHECKED		
APPROVED		

SR #: 1257614 AI#: F6949
 DESIGN #: 222514
 PRODUCT #: 386440
 AI #: F6949
 DWO #: 6044-6900
 MSR #: N/A
 JPA #: N/A
 PROJECT ID #: 923833
 RELATED WO#: 9-2238, 6044-2040

EX: 813936E
 50'
 RM: 15/16kVA 120/240v 1P 3W (FUSED INTERNALLY)
 SN: C2336617
 IN: 37.5/16 kVA 120/240v 1P 3W
 SN:
 IN: 2-CUTOUTS
 IN: SECONDARY GROUND
 IN: TRANSFER SECONDARIES

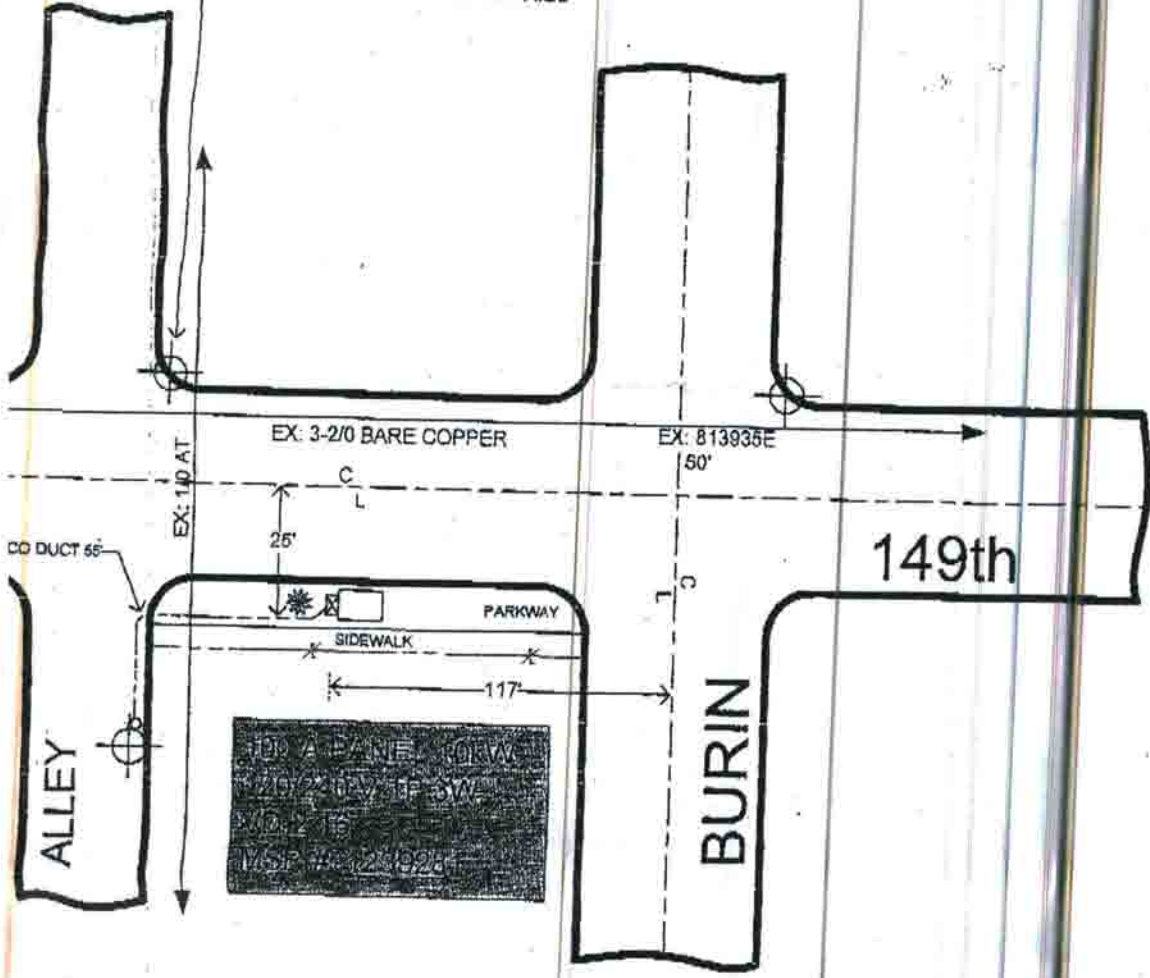

Michael Glenn	Job Name:	7465549		
Michael Glenn	Job Location:	4443 W. 149TH STREET LAWRENDALE		
222502	District:	44-SOUTHBAY		
#: 386428	Circuit:	ZEBRA 16KV	Voltage Drop:	2.16
8-2238	Substation:	EL NIDO	Flicker:	
6044-2040	Foreman:			
1239281	Truck:	Yes		
	TLM DATA:	Size (kVA)	kVA	%Load
0(s):	Existing:	15.00	36.10	240.67
	Proposed:	37.50	45.00	120.00

Vicinity Map:	
CREVIERA	ALLEY
149TH ST.	BURIN
	JUNWORTH
Inv. Map #'s:	45-65D
Thomas	LA 733 C4

N

NOT TO SCALE

SCE Technical Planning
 Dominguez Hills, CA
 Michael Glenn

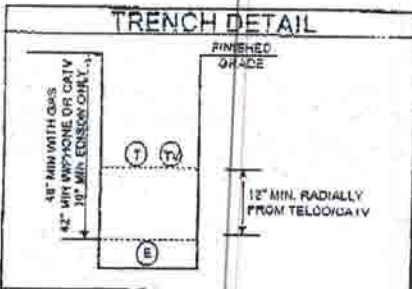

USE AT STATION 679272H
NOTICE PTX.



UNDERGROUND SERVICE ALERT

(800) 642-2444

Call USA for underground locating
2 working days before you dig.

WARNING

THE EXCAVATOR MUST TAKE ALL STEPS NECESSARY TO AVOID CONTACT WITH UNDERGROUND FACILITIES WHICH MAY RESULT IN INJURY TO PERSONS OR DAMAGE TO FACILITIES IN THE AREA. THE INDICATED LOCATIONS OF EDISON UNDERGROUND FACILITIES, AS PROVIDED, ARE BELIEVED TO BE ACCURATE. HOWEVER, THE FINAL DETERMINATION OF EXACT LOCATIONS AND THE COSTS OF REPAIR TO DAMAGED FACILITIES IS THE RESPONSIBILITY OF THE EXCAVATOR.

48 Hour Notice

SCE Inspections are scheduled 48 hours in advance. For pre-construction and job inspection, please call (909) 421-6493

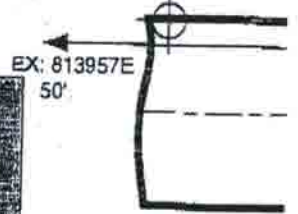

Picture or Single Line

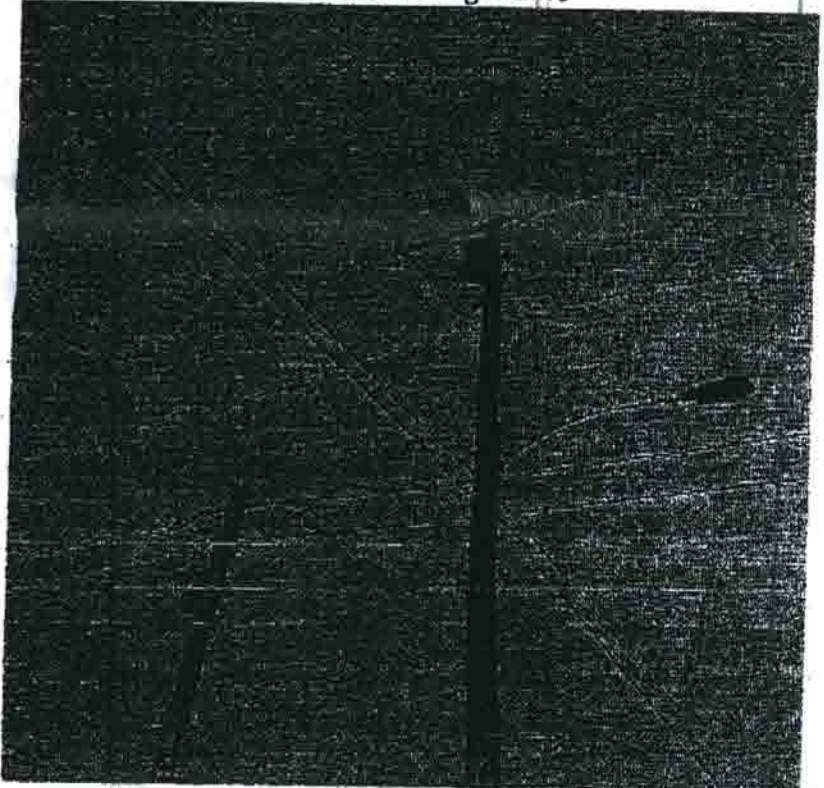

- EX: 679272H
- 30' POLE (WITH 5' PTX) TO
- IN: 3"-2" RISER
- IN: 166 ROLLER
- IN: HY-PLUGS #2
- IN: 85' 3-1/C 2-#2 1-#4 CLP 600
- IN: ZMTR 108

Notes to Crew

EPL: PASSES BOTH DIRECTIONS
CREW TO INSTALL FUSE ARM FOR CUTOUTS.
TRANSFORMER WILL HAVE TO BE INSTALLED LOWER.
BUCK ARM MAY BE NEEDED TO MAKE CLEARANCES FROM SECONDARIES

F
F
F
F
F
F
F
F
F
F
F

LICENSED CONTRACTOR'S DECLARATION

I hereby affirm under penalty of perjury that I am licensed under provisions of Chapter 9 (commencing with Section 7000) of Division 3 of the Business and Professions Code, and my license is in full force and effect.

License Class C-10 Lic No 429590
Shahu Kelly H 1-25-10
Contractor's Signature Date

OWNER-BUILDER DECLARATION

I hereby affirm under penalty of perjury that I am exempt from the Contractors License Law for the following reason (Sec. 7031.5, Business and Professions Code, any city or county which requires a permit to construct, alter, improve, demolish, or repair any structure, the issuance, also requires the applicant for such permit to file a signed statement that he or she is licensed pursuant to the provisions of the Contractors License Law (Chapter 9 (commencing with Section 7000) of Division 3 of the Business and Professions Code) or that he or she is exempt therefrom and the basis for the alleged exemption. Any violation of Section 7031.5 by any applicant for a permit subjects the applicant to a civil penalty of not more than five hundred dollars (\$500):

I am exempt under Sec _____, B & P.C. for this reason:

[Electrical, Plumbing & Sewer Permits Only]

I, as owner of the property, will do the work, and the structure is not intended or offered for sale (Sec. 7044, Business and Professions Code; The Contractors License Law does not apply to an owner of property who builds or improves thereon, and who does such work himself or herself, provided that such improvements are not intended or offered for sale. If, however, the building or improvement is sold within one year of completion, the owner-builder will have the burden of proving that he or she did not build or improve for the purpose of sale.)

[All Other Permits]

I, as owner of the property, or my employees with wages as their sole compensation, will do the work, and the structure is not intended or offered for sale (Sec. 7044, Business and Professions Code; The Contractors License Law does not apply to an owner of property who builds or improves thereon, and who does such work himself or herself or through his or her own employees, provided that such improvements are not intended or offered for sale. If, however, the building or improvement is sold within one year of completion, the owner-builder will have the burden of proving that he or she did not build or improve for the purpose of sale.)

I, as owner of the property, am exclusively contracting with licensed contractors to construct the project (Sec. 7044, Business and Professions Code; The Contractors License Law does not apply to an owner of property who builds or improves thereon, and who contracts for such projects with a contractor(s) licensed pursuant to the Contractors License Law.)

Shahu Kelly H 1-25-10
Owner Signature Date

WORKER'S COMPENSATION DECLARATION

I hereby affirm under penalty of perjury one of the following declarations:

I have and will maintain a certificate of consent to self-insure for worker's compensation, as provided for by Section 3700 of the Labor Code, for the performance of the work for which this permit is issued.

I have and will maintain worker's compensation insurance, as required by Section 3700 of the Labor Code, for the performance of the work for which this permit is issued. My worker's compensation insurance carrier and policy number are:

Carrier _____

Policy Number _____

I certify that in the performance of the work for which this permit is issued, I shall not employ any person in the manner so as to become subject to the worker's compensation laws of California, and agree that I should become subject to the worker's compensation provisions of Section 3700 of the Labor Code, I shall forthwith comply with those provisions.

Shahu Kelly H 1-25-10
Applicant Signature Date

WARNING: FAILURE TO SECURE WORKER'S COMPENSATION COVERAGE IS UNLAWFUL, AND SHALL SUBJECT AN EMPLOYER TO CRIMINAL PENALTIES AND CIVIL FINES UP TO ONE HUNDRED THOUSAND DOLLARS (\$100,000), IN ADDITION TO THE COST OF COMPENSATION, DAMAGES AS PROVIDED FOR IN SECTION 3706 OF THE LABOR CODE, INTEREST, AND ATTORNEY'S FEES.

JOB ADDRESS
LOCALITY

HAZARDOUS MATERIAL DECLARATION

Will the applicant or future building occupant handle a hazardous material or a mixture containing a hazardous material equal to or greater than the amount specified on the hazardous materials information guide?

Yes No

Will the intended use of the building by the applicant or future building occupant require a permit for construction or modification from the South Coast Air Quality Management District (SCAQMD)? See permitting checklist for guidelines.

Yes No

I have read the hazardous materials information guide and the SCAQMD permitting checklist, I understand my requirements under the Los Angeles County Code Title 2, Chapter 220 Sections 220.100 through 220.140 concerning hazardous material reporting and for obtaining a permit from the SCAQMD.

ASBESTOS NOTIFICATION

Notification letter sent to SCAQMD or EPA.

I declare that notification of asbestos removal is not applicable to addressed project.

CONSTRUCTION LENDING AGENCY

I hereby affirm under penalty of perjury that there is a construction lending agency for the performance of the work for which this permit is issued (Sec. 3097, Civ.C.)

Lender's Name _____

Lender's Address _____



I certify that I have read this application and state under the penalty of perjury that the above information is correct. I agree to comply with all City and County ordinances and State laws relating to building construction, and hereby authorize representatives of this County to enter upon the above-mentioned property for inspection purposes.

Applicant or Agent Signature

Date

REL 1 A507 7465549-311704
INSTRUCTIONS TO APPLICANT

MODE + POWER
IMPORTANT
Use Ball Point Pen.
Press Firmly. No Erasures Allowed.

PUBLIC WORKS DEPARTMENT PERMIT

<p style="text-align: center;">CITY OF LAWDALE PUBLIC WORKS (310) 973-3260 24 HOURS NOTICE REQUIRED FOR ALL INSPECTIONS</p> <p style="text-align: center;">FOR THE APPLICANT TO FILL IN</p> <p>BUILDING ADDRESS: <u>OPP 4443 W. 149th St.</u> OWNER: _____</p> <p>MAIL ADDRESS: _____</p> <p>CITY & ZIP: _____ TEL. NO.: _____</p> <p>PERMITTEE: <u>AT&T</u></p> <p>ADDRESS: <u>100 W. ALONDRA BL. RMA102</u> CITY & ZIP: <u>GARDENA 90248</u> TEL. NO.: <u>310-515-2461</u> STATE LIC. NO.: _____ CITY LIC. NO.: _____ EMERGENCY TEL. NO.: _____</p> <p style="text-align: center;">SPECIAL REQUIREMENTS</p> <p>① 24 inch set back from curb face to cabinet face</p> <p>② Concrete pad for cabinet to be at grade with sidewalk</p> <p>③ Provide a minimum of 48 inches of ADA sidewalk all the way</p> <p style="text-align: center;">DESCRIPTION OF WORK</p> <p><u>Plc one concrete pad & AGF. Also plc 21' 1-4" UG Conduit from SAI location to new AGF location. Plc 5' 1-3 duct (Riser only) + 55 1-3" PWR Duct</u> <u>A507-7465549</u></p> <p>STARTING DATE: <u>9-17-09</u> EST. DATE OF COMPLETION: <u>3-17-10</u> I HEREBY ACKNOWLEDGE THAT I HAVE READ THIS APPLICATION AND STATE THAT THE INFORMATION GIVEN IS CORRECT.</p> <p>I AGREE TO COMPLY WITH ALL APPLICABLE CITY ORDINANCES AND STATE LAWS AND WITH THE REQUIREMENTS OF THIS PERMIT.</p> <p>I CERTIFY THAT I POSSESS A CURRENT WORKMEN'S COMPENSATION AND \$1 MILLION GENERAL LIABILITY INSURANCE POLICY.</p> <p>DATE OF EXPIRATION: <u>3-17-10</u></p> <p>SIGNATURE OF PERMITTEE OR AGENT: <u>[Signature]</u> ADDRESS: _____ AGENT MUST BE AUTHORIZED IN WRITING</p>	<p style="text-align: right;">PERMITTEE'S COPY</p> <p>PERMIT NO. <u>6025</u> ISSUED BY <u>FRS</u> DATE ISSUED <u>12/7/09</u></p> <p style="font-size: small;">THIS PERMIT OR CERTIFIED COPY MUST BE KEPT ON THE JOB SITE TO BE SHOWN ANY AUTHORIZED AGENT OF THE CITY ON REQUEST.</p> <p style="text-align: center;">PERMITTEE SHALL CALL PUBLIC WORKS FOR INSPECTIONS CHECKED BELOW:</p> <table border="1" style="width: 100%; border-collapse: collapse;"> <thead> <tr> <th style="width: 60%;"></th> <th style="width: 20%;">DATE</th> <th style="width: 20%;">INSPECTOR</th> </tr> </thead> <tbody> <tr><td><input type="checkbox"/> CONTINUOUS</td><td>_____</td><td>_____</td></tr> <tr><td><input type="checkbox"/> EXCAVATION</td><td>_____</td><td>_____</td></tr> <tr><td><input type="checkbox"/> FORMS</td><td>_____</td><td>_____</td></tr> <tr><td><input type="checkbox"/> BACKFILL</td><td>_____</td><td>_____</td></tr> <tr><td><input type="checkbox"/> PAVEMENT</td><td>_____</td><td>_____</td></tr> <tr><td><input type="checkbox"/> SADDLE (PRIOR TO TAP)</td><td>_____</td><td>_____</td></tr> <tr><td><input type="checkbox"/> PRIOR TO BACKFILL</td><td>_____</td><td>_____</td></tr> <tr><td><input type="checkbox"/> PRIOR TO CURB CUT</td><td>_____</td><td>_____</td></tr> <tr><td><input type="checkbox"/> _____</td><td>_____</td><td>_____</td></tr> <tr><td><input type="checkbox"/> FINAL</td><td>_____</td><td>_____</td></tr> <tr><td><input type="checkbox"/> _____</td><td>_____</td><td>_____</td></tr> </tbody> </table> <table border="1" style="width: 100%; border-collapse: collapse;"> <thead> <tr> <th style="width: 60%;">DESCRIPTION OF WORK</th> <th style="width: 10%;">SPECIAL DEPOSIT</th> <th style="width: 10%;">#</th> <th style="width: 20%;">FEE</th> </tr> </thead> <tbody> <tr><td>SIDEWALK</td><td></td><td></td><td>\$</td></tr> <tr><td>CURB & GUTTER</td><td></td><td></td><td>\$</td></tr> <tr><td>DRIVEWAY</td><td></td><td></td><td>\$</td></tr> <tr><td>CURB DRAIN</td><td></td><td></td><td>\$</td></tr> <tr><td>1 HR OF INSP. TIME</td><td>75.00</td><td>4</td><td>\$300.00</td></tr> <tr><td>UNDERGROUND UTILITIES/TRENCHING</td><td>140.00</td><td>1</td><td>\$140.00</td></tr> <tr><td>STREET REPAIR</td><td>40.00</td><td>1</td><td>\$140.00</td></tr> <tr><td>OTHER</td><td>65</td><td>1</td><td>\$65.00</td></tr> <tr><td>ENCROACHMENT</td><td></td><td></td><td></td></tr> <tr><td colspan="3" style="text-align: right;">TOTAL \$</td><td>645.00</td></tr> </tbody> </table> <p>RETURN DEPOSIT TO: _____</p> <p style="text-align: center;">APPROVAL FOR RELEASE</p> <p>INSPECTOR'S SIGNATURE: _____ DATE: _____</p>		DATE	INSPECTOR	<input type="checkbox"/> CONTINUOUS	_____	_____	<input type="checkbox"/> EXCAVATION	_____	_____	<input type="checkbox"/> FORMS	_____	_____	<input type="checkbox"/> BACKFILL	_____	_____	<input type="checkbox"/> PAVEMENT	_____	_____	<input type="checkbox"/> SADDLE (PRIOR TO TAP)	_____	_____	<input type="checkbox"/> PRIOR TO BACKFILL	_____	_____	<input type="checkbox"/> PRIOR TO CURB CUT	_____	_____	<input type="checkbox"/> _____	_____	_____	<input type="checkbox"/> FINAL	_____	_____	<input type="checkbox"/> _____	_____	_____	DESCRIPTION OF WORK	SPECIAL DEPOSIT	#	FEE	SIDEWALK			\$	CURB & GUTTER			\$	DRIVEWAY			\$	CURB DRAIN			\$	1 HR OF INSP. TIME	75.00	4	\$300.00	UNDERGROUND UTILITIES/TRENCHING	140.00	1	\$140.00	STREET REPAIR	40.00	1	\$140.00	OTHER	65	1	\$65.00	ENCROACHMENT				TOTAL \$			645.00
	DATE	INSPECTOR																																																																															
<input type="checkbox"/> CONTINUOUS	_____	_____																																																																															
<input type="checkbox"/> EXCAVATION	_____	_____																																																																															
<input type="checkbox"/> FORMS	_____	_____																																																																															
<input type="checkbox"/> BACKFILL	_____	_____																																																																															
<input type="checkbox"/> PAVEMENT	_____	_____																																																																															
<input type="checkbox"/> SADDLE (PRIOR TO TAP)	_____	_____																																																																															
<input type="checkbox"/> PRIOR TO BACKFILL	_____	_____																																																																															
<input type="checkbox"/> PRIOR TO CURB CUT	_____	_____																																																																															
<input type="checkbox"/> _____	_____	_____																																																																															
<input type="checkbox"/> FINAL	_____	_____																																																																															
<input type="checkbox"/> _____	_____	_____																																																																															
DESCRIPTION OF WORK	SPECIAL DEPOSIT	#	FEE																																																																														
SIDEWALK			\$																																																																														
CURB & GUTTER			\$																																																																														
DRIVEWAY			\$																																																																														
CURB DRAIN			\$																																																																														
1 HR OF INSP. TIME	75.00	4	\$300.00																																																																														
UNDERGROUND UTILITIES/TRENCHING	140.00	1	\$140.00																																																																														
STREET REPAIR	40.00	1	\$140.00																																																																														
OTHER	65	1	\$65.00																																																																														
ENCROACHMENT																																																																																	
TOTAL \$			645.00																																																																														

NOTE: THIS PERMIT SHALL BECOME VOID UNLESS THE WORK THEREBY PERMITTED IS COMMENCED AND DILIGENTLY PURSUED WITHIN 60 DAYS FROM ISSUANCE.

REV. 3/22/07

PLEASE CALL ALLYSON @ 310-973-3294 (24 Hrs. in ADVANCE OF WORK)

JOB
ADDRESS

4446 4 W. 149TH ST

OWNER

① NEW PEDESTAL
SVC O.K.

1-26-10 3/1/10

4443 IS
WRONG ADDRESS
SHOULD
BE
4444

DATE

INSPECTOR'S SIGNATURE