

4443 West 149th Street

Lawndale

APPLICATION FOR BUILDING PERMIT

COUNTY OF LOS ANGELES
 DEPARTMENT OF COUNTY ENGINEER
 BUILDING AND SAFETY DIVISION
 JOHN A. LAMBIE, COUNTY ENGINEER
 COLEMAN W. JENKINS, SUPT OF BUILDING

BUILDING ADDRESS 4443 W. 149 ST.			
LOCALITY LAWDALE			
NEAREST CROSS ST. GREVILLEA AVE			
DISTRICT NO. 7.01	GROUP J	TYPE CONST. II	PROCESSED BY GRIPATH
STATISTICAL CLASSIFICATION CLASS NO. #8 DWELL. UNITS \pm 0 G BKIC1PG			SEWER MAP
USE ZONE R-1	MAP NO. 4155		
SPECIAL CONDITIONS			
BLDG. SETBACK FROM FRONT PROP. LINE OF W. 149 ST. (STREET)			
TYPE OF HIGHWAY	EXISTING WIDTH	SETBACK FROM C.L.	HIGHWAY + YARD = TOTAL
Local	60'	50'	0' + 20' = 20'
BLDG. SETBACK FROM SIDE PROP. LINE OF (STREET)			
TYPE OF HIGHWAY	EXISTING WIDTH	SETBACK FROM C.L.	HIGHWAY + YARD = TOTAL
			+ =
CORNER CUTOFF YES <input type="checkbox"/> NO <input type="checkbox"/>			
SEE REVERSE SIDE FOR SPECIAL APPROVALS			
5-15-69 - BLOG BUILT WITHOUT PERMIT, OR INSPECTION INSPECTION REVEALS THAT STRUCTURE CONFORMS WITH MINIMUM CODE STANDARDS. FOR PRIVATE STORAGE BLOG.			
APPROVALS		DATE	INSPECTOR'S SIGNATURE
FOUNDATION: LOCATION FORMS, MATERIALS		/	
FRAME: FIRE STOPS, BRACING, BOLTS			
FURNACE: LOCATION, GAS VENT, DUCTS			
LATH, INT.			
LATH, EXT.			
HOUSE NUMBER CORRECT AND POSTED			
FINAL *		5-15-69	GRIPATH

FOR APPLICANT TO FILL IN (Print or type only)			
BUILDING ADDRESS 4443 W. 149 ST.			
LOT NO. W 40' OF LOTS 38-39-40 BLOCK 9			
TRACT LAWDALE ACRES			
SIZE OF LOT 40x75	NO. OF BLDGS. NOW ON LOT 1		
USE OF EXISTING BLDG. RES BY ATTIC GAR.			
OWNER MANUEL MORENO			
ADDRESS 4443 W. 149 ST.			
CITY LAWDALE			
ARCHITECT OR ENGINEER	TEL. NO.		
ADDRESS OWNER			
CONTRACTOR	TEL. NO.		
ADDRESS			
CITY	LIC. CLASS		
DESCRIPTION OF WORK			
<input checked="" type="checkbox"/> NEW	<input type="checkbox"/> ADD	<input type="checkbox"/> ALTER	<input type="checkbox"/> REPAIR
<input type="checkbox"/> DEMOLISH			
SQ. FT. SIZE 150 Φ1	NO. OF STORIES 1	NO. OF FAMILIES -	
USE OF STRUCTURE PVT. STORAGE BLDG.			
SIGNATURE OF APPLICANT			
VALUATION \$ 600⁰⁰			
P.C. FEE \$	PMT. FEE \$ 6⁰⁰		
I HEREBY ACKNOWLEDGE THAT I HAVE READ THIS APPLICATION AND STATE THAT THE ABOVE IS CORRECT AND AGREE TO COMPLY WITH ALL COUNTY ORDINANCES AND STATE LAWS REGULATING BUILDING CONSTRUCTION. I CERTIFY THAT IN DOING THE WORK AUTHORIZED HEREBY I WILL NOT EMPLOY ANY PERSON IN VIOLATION OF THE LABOR CODE OF THE STATE OF CALIFORNIA RELATING TO WORKMEN'S COMPENSATION INSURANCE.			
SIGNATURE OF PERMITTEE Manuel Moreno			
ADDRESS			

PLAN CHECK VALIDATION

CK. M.O. CASH

JOHN F. LEWIS, PRINCIPAL STRUCTURAL ENGINEER
 PERMIT VALIDATION CK. M.O. **CASH**

LAC 540369 MAY 14

6.00

INSPECTOR COPY GRIPATH

GRIPATH

	REQUIRED (YES OR NO)	RECEIVED.
WATER CERTIFICATE		
ROAD DEPT. APPROVAL		
HEALTH DEPT. APPROVAL		
FIRE DEPT. APPROVAL		
GRADING APPROVAL		
GEOLOGICAL APPROVAL		
PEDESTRIAN PROTECTION (FENCE) (CANOPY)		
SPECIAL INSPECTION ON (CONC.) (Masonry) (WELDG.)		

DEPARTMENT OF BUILDING AND SAFETY
COUNTY OF LOS ANGELES

WM. J. FOX, CHIEF ENGINEER

BUILDING

APPLICATION

1

FOR APPLICANT TO FILL IN

BUILDING ADDRESS **4443 W. 149 ST.**

LOCALITY **LAWNDALE**

NEAREST CROSS ST. **GREVILLEA**

OWNER **A. W. O'Connell**
MAIL ADDRESS **14821 BURIN AVE.**

CITY **LAWNDALE** TEL. NO.

ARCHITECT OR ENGINEER TEL. NO.

ADDRESS

CONTRACTOR **SELF** TEL. NO.

ADDRESS **14821 BURIN AVE. LAWNDALE**

LEGAL DESCRIPTION **WEST 40 OF LOT NO. 38-39-40 BLOCK 9**

TRACT **LAWNDALE**

40 X 75 WEST 40 SIZE OF LOT **38-39-40** NO. OF BLDGS. NOW ON LOT

USE OF EXISTING BLDG. **—** NO. OF FAMILIES **—**

DESCRIPTION OF WORK

NEW ALTERATION ADDITION

REPAIR DEMOLITION

SQ. FT. SIZE **884** NO. OF ROOMS **5** STORIES

EXT. WALL COVERING **STUCCO** ROOF COVERING **15 SHINGLES**

USE OF STRUCTURE **RESIDENCE**

INSPECTION FOR OCCUPANCY AS **HOME**

I HEREBY ACKNOWLEDGE THAT I HAVE READ THIS APPLICATION AND STATE THAT THE INFORMATION GIVEN IS CORRECT.

I AGREE TO COMPLY WITH ALL COUNTY ORDINANCES AND STATE LAWS REGULATING BUILDING CONSTRUCTION.

SIGNATURE OF PERMITTEE **A. W. O'Connell**

ADDRESS **14821 Burin Ave.**

AUTHORIZED AGT.

\$ **7000.00**

P. C. \$ **12.00**
FEE

\$ **24.00**
FEE

FOR OFFICE USE ONLY

DISTRICT NO. **7** PLAN, CK. OR REC. NO. **59358** PERMIT NO. **01416**

RECEIVED BY **GRIT** DATE OF APPL. **10-6-52** DATE ISSUED **10-6-52**

BUILDING ADDRESS **4443 W. 149 ST.**

LOCALITY **LAWNDALE**
NEAREST CROSS ST. **GREVILLEA**

FIRE ZONE **—** NO. OF PLANS **2** TYPE **II** GROUP **I**

BLDG. SETBACK LINE **20** F.R.L. **1254** ORD. NO.

USE ZONE **R-2** APPROVED BY **—** DATE

HOUSE NUMBERING
MAP NUMBER **4155** NO. ASSIGNED BY **GRIT**

CORRECTIONS
5/8/53 See 4433 W 149 St
for Corrections

6/10/53 W. Fire wall Repair
North Garage wall not built
Property Here Same owner
Call

ORIGINAL

APPROVALS

INSPECTOR'S SIGNATURE DATE

FOUNDATION: LOCATION FORMS, MATERIALS **10/7/52**

FRAME: FIRE STOPS, BRACING, BOLTS **5/29/53**

FURNACE: LOCATION, GAS VENT, DUCTS

LATH, INT. **6/10/53**

LATH, EXT.

PLASTER, INT. **Jeffery** **7-28-53**

PLASTER, EXT.

HOUSE NUMBER CORRECT AND POSTED **Jeffery** **7-29-53**

FINAL **Jeffery** **8-5-53**

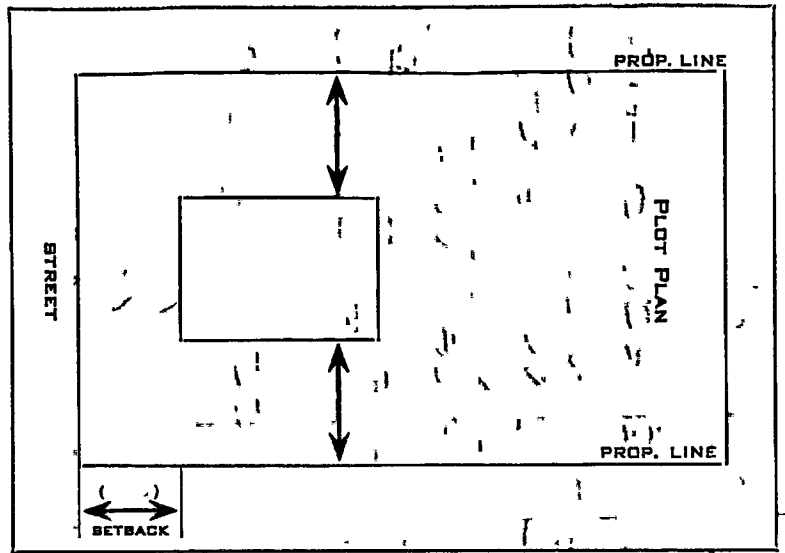

DEPARTMENT OF COUNTY ENGINEER
 DIVISION OF BUILDING AND SAFETY
 COUNTY OF LOS ANGELES
 WILLIAM J. FOX, COUNTY ENGINEER
 CASSATT D. GRIFFIN, SUP'T OF BUILDING

BUILDING

1

APPLICATION

FOR APPLICANT TO FILL IN

BUILDING ADDRESS 4443 W 149th St

LOCALITY LAWDALE

NEAREST CROSS ST. BURIN AVE - 147th ST.

OWNER DUANE REED

MAIL ADDRESS 14821 Burin Ave

CITY LAWDALE CAL TEL. NO. _____

ARCHITECT OR ENGINEER TEL. NO. _____

ADDRESS _____

CONTRACTOR SELF TEL. NO. _____

ADDRESS _____

LEGAL DESCRIPTION _____ LOT NO. 34-2940 BLOCK 9

TRACT LAWDALE APTS

SIZE OF LOT 40x75 NO. OF BLDGS. NOW ON LOT 3

USE OF EXISTING BLDG. HOUSE NO. OF FAMILIES _____

DESCRIPTION OF WORK

NEW	<input checked="" type="checkbox"/>	ALTERATION	<input type="checkbox"/>	ADDITION	<input type="checkbox"/>
REPAIR	<input type="checkbox"/>	DEMOLITION	<input type="checkbox"/>		
SQ. FT. SIZE	<u>14 x 20</u>	NO. OF ROOMS		STORIES	
EXT. WALL COVERING	<u>STUCCO</u>	ROOF COVERING	<u>ASPHALT</u>		
USE OF STRUCTURE	<u>GARAGE</u>				

I HEREBY ACKNOWLEDGE THAT I HAVE READ THIS APPLICATION AND STATE THAT THE INFORMATION GIVEN IS CORRECT.

I AGREE TO COMPLY WITH ALL COUNTY ORDINANCES AND STATE LAWS REGULATING BUILDING CONSTRUCTION.

SIGNATURE OF PERMITTEE Duane Reed

ADDRESS 14821 Burin Ave

AUTHORIZED AGT. Duane Reed

\$ 700
 VALUATION

P. C. S. FEE _____
 FEE \$ 450

FOR OFFICE USE ONLY

DISTRICT NO. 7 PLAN CK. OR REC. NO. _____ PERMIT NO. 12297

RECEIVED BY WJ Fox DATE OF APPL. _____ DATE ISSUED 2-16-53

BUILDING ADDRESS 4443 W 149 ST

LOCALITY LAWDALE

NEAREST CROSS ST. BURIN

FIRE ZONE _____ NO. OF PLANS _____ TYPE V GROUP J

BLDG. SETBACK LINE 20 SPL ORD. NO. 1957

USE ZONE A-1 APPROVED BY _____ DATE _____

HOUSE NUMBERING

MAP NUMBER 4155 NO. ASSIGNED BY _____

CORRECTIONS

4453 garage attached to rear of lot

Revised Pl. & Elev.

APPROVALS

INSPECTOR'S SIGNATURE _____ DATE _____

FOUNDATION, LOCATION, FORMS, MATERIALS 3/4/53 P. Allen

FRAME: FIRE STOPS, BRACING, BOLTS _____

FURNACE: LOCATION, GAS VENT, DUCTS _____

LATH, INT. _____

LATH, EXT. _____

PLASTER, INT. _____

PLASTER, EXT. _____

HOUSE NUMBER CORRECT AND POSTED _____

FINAL Reflected 7-29-53

ORIGINAL

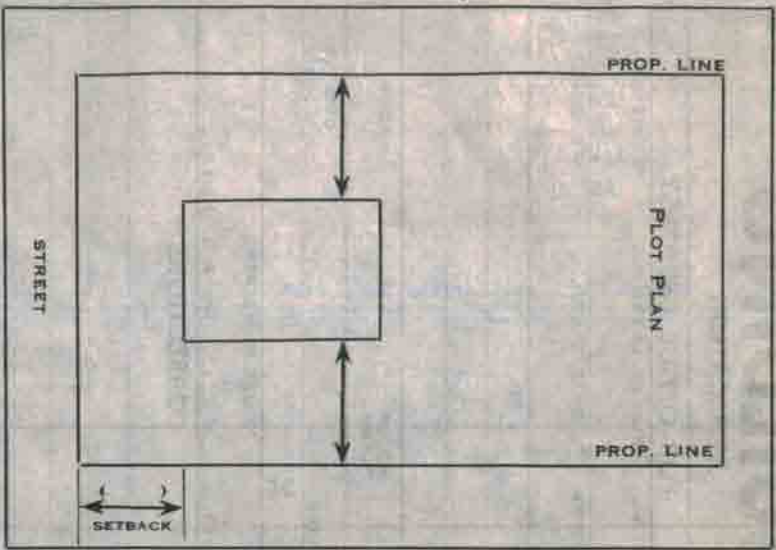

THE CITY OF WASHINGTON

THE DISTRICT OF COLUMBIA
 DEPARTMENT OF PUBLIC WORKS
 ENGINEERING DIVISION
 1100 PENNSYLVANIA AVENUE, N.W.
 WASHINGTON, D.C. 20004

PLAT OF

SECTION 10, TOWNSHIP 38 NORTH, RANGE 12 WEST, DISTRICT OF COLUMBIA

1000 SQUARE FEET

1000

1000

1000

1000

1000

1000

1000

1000

1000

1000

1000

1000

1000

1000

1000

1000

1000

1000

1000

1000

1000

1000

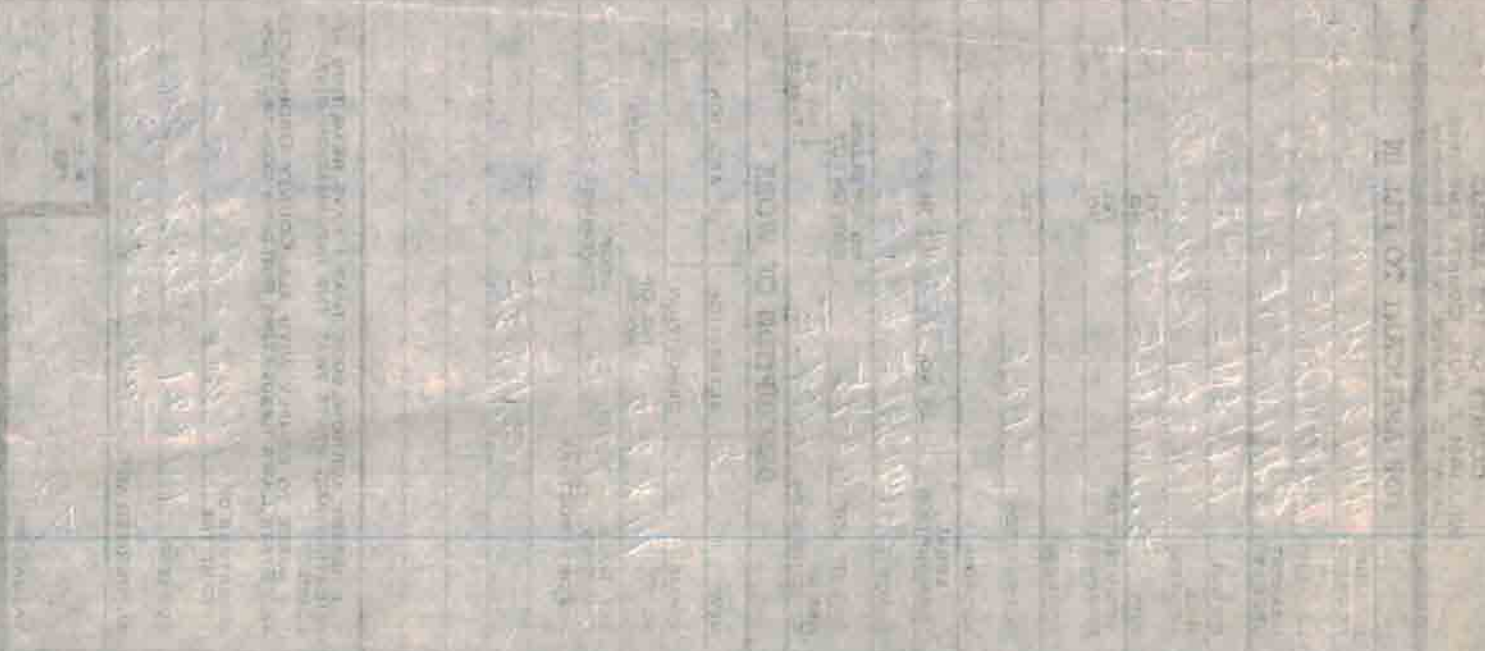

CITY OF LAWDALE APPLICATION FOR ELECTRICAL PERMIT

1

COUNTY OF LOS ANGELES
DEPARTMENT OF COUNTY ENGINEER
BUILDING AND SAFETY DIVISION
JOHN A. LAMBIE, COUNTY ENGINEER
COLEMAN W. JENKINS, SUPERINTENDENT OF BUILDING

BUILDING ADDRESS 4443 W. 149 ST.	
LOCALITY LAWDALE	NEAREST CROSS ST. GREVILLEA AVE
OWNER MANUEL MORENO	
MAIL ADDRESS SAME	
CITY	TEL. NO.
PLAN CHECK APPLICANT	
ADDRESS	
CITY	TEL. NO.
CONTRACTOR	
ADDRESS	
CITY	TEL. NO.
LICENSE NO.	CLASS.
I HEREBY ACKNOWLEDGE THAT I HAVE READ THIS APPLICATION AND STATE THAT THE ABOVE IS CORRECT AND AGREE TO COMPLY WITH ALL COUNTY ORDINANCES AND STATE LAWS REGULATING ELECTRICAL WIRING.	
I HEREBY CERTIFY THAT I AM PROPERLY REGISTERED AND/OR LICENSED AS REQUIRED BY LOS ANGELES COUNTY AND STATE OF CALIFORNIA OR THAT I AM THE LEGAL OWNER OF, AND INTEND TO RESIDE IN, THE ABOVE DESCRIBED RESIDENTIAL PROPERTY.	
SIGNATURE OF PERMITTEE <i>Manuel Moreno</i>	

FOR APPLICANT TO FILL IN

		NO. EACH		FEE	
				\$	\$
RECEPT 2	TOTAL	FIRST 20	6	.20	1.20
LIGHT 2		OVER 20		.10	
SWITCH 2		6			
LIGHTING 2	TOTAL	FIRST 20	2	.20	.40
FIXTURES 2		OVER 20		.10	
RANGE DRYER WTR. HTR.					
STA. COOK DISP. F.A.U.					
SPACE HTR. AIR COND.					
CLOTHES WASH. DISHWASH.					
FAN OTHER					
MOTORS, TRANSFORMERS IND. HEATERS, ETC. SIZE & TYPE		RATING HP. KW. KVA. OVER TO			
		0 - 1		1.00	
		1 - 10		3.00	
		10 - 50		5.00	
		50 - 100		10.00	
		100 - 500		15.00	
SIGN GAS TUBE, OR MARQUEE	SIGN AND ONE CIRCUIT			3.00	
	ADDITIONAL CIRCUITS			1.00	
SERVICE NOT OVER 600 VOLTS OR 200 AMP				2.00	
SERVICE OVER 600 VOLTS OR 200 AMP				5.00	
TEMP SERVICE, POLE, & APPURTENANCES				3.00	
PERMIT FEE (SUB TOTAL)					
PLAN CHECK FEE (50% PERMIT FEE)					
PERMIT ISSUING FEE				2.00	2.00
SUPPLEMENTARY PERMIT ISSUING FEE				1.00	
TOTAL FEE					3.60

DISTRICT NO.	GROUP	ZONE	PROCESSED BY
NOTES:			
APPROVALS	DATE	INSPECTOR'S SIGNATURE	
TEMP. POWER POLE			
UNDERSLAB WORK			
ROUGH CONDUIT			
WIRING			
FIXTURES	5-15-69	<i>Chapman</i>	
POWER AUTHORIZED			
UTILITY CO. NOTIFIED			
FINAL	5-15-69	<i>Chapman</i>	

PLAN CHECK VALIDATION CK. M.O. CASH

PERMIT VALIDATION CK M.O. **CASH**

L/Co 540469 MAY 14 2 3.60

INSPECTOR COPY

